

2-Way Power Divider

P/N: JXWBGF-T-2-0-1200

Frequency Range(GHz)	DC-1.2
Insertion Loss(dB)	7 max
Isolation(dB)	6 min
VSWR	1.25 max
Amplitude Balance(dB)	0.3 max
Phase Balance(°)	0.5 max
Connector	SMA-Female
Operating Temperature(°C)	-40 ~ +70
Remark	DC Coupled(the DC Current must go thru)
Net Weight(Kg)	0.06 Around

Outline Drawing

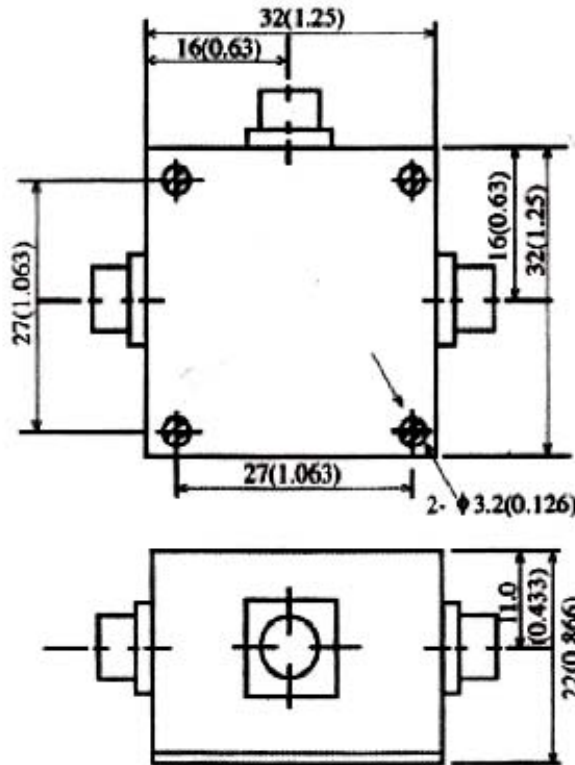

For current data sheets, please contact: sales@aacix.com