

RoHS Compliant Product

A suffix of "-C" specifies halogen & lead-free

**SOT-343**

**FEATURES**

- \*Low current rectification
- \*High reliability

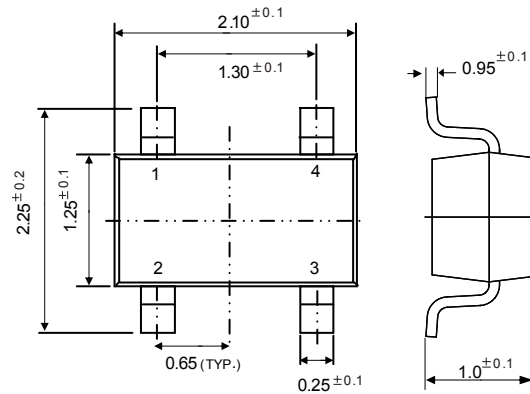
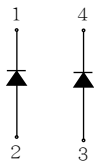

**MARKING: 3U**

Unit:mm

**Maximum Ratings and Electrical Characteristics, Single Diode @T<sub>A</sub>=25°C**

Parameter	Symbol	Limits	Unit
Peak reverse voltage	V <sub>RM</sub>	30	V
DC reverse	V <sub>R</sub>	30	V
Peak forward surge current	I <sub>FSM</sub>	1	A
Mean rectifying current	I <sub>O</sub>	0.2	A
Junction temperature	T <sub>J</sub>	125	°C
Storage temperature	T <sub>stg</sub>	-40~+125	°C

60 Hz for 1 cycle

Electrical Ratings @T<sub>A</sub>=25°C

Parameter	Symbol	Min.	Typ.	Max.	Unit	Conditions
Forward voltage	V <sub>F</sub>			0.28	V	I <sub>F</sub> =1mA
				0.33		I <sub>F</sub> =10mA
				0.43		I <sub>F</sub> =100mA
				0.5		I <sub>F</sub> =200mA
Reverse current	I <sub>R</sub>			30	µA	V <sub>R</sub> =10V

## Typical Characteristics

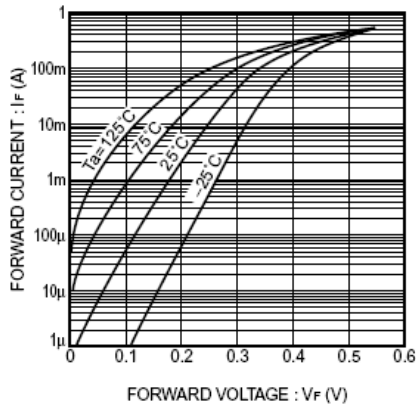

Fig. 1 Forward temperature characteristic

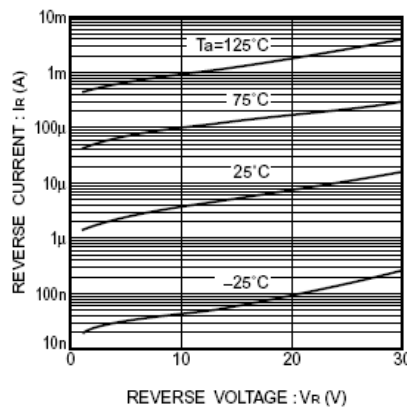

Fig. 2 Reverse temperature characteristic

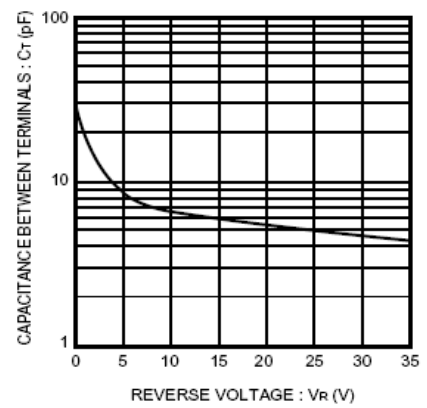

Fig. 3 Capacitance between terminals characteristic