

SPECIFICATION FOR APPROVAL

REF : 20080714-B

PAGE: 1

PROD. NAME	RADIAL INDUCTOR	ABC'S DWG NO. ABC'S ITEM NO.	RB0812□□□□L□-□□□
---------------	-----------------	---------------------------------	------------------

I . CONFIGURATION & DIMENSIONS :

Marking :

" ● " : Start

● 101----100 uH (Inductance code)

A	: 6.7±0.5		m/m
B	: 10.0±1.0		m/m
C	: 25.0±5		m/m
D	: 18.0±5		m/m
E	: 2.5 max.		m/m
F	: 3.0±0.5		m/m
Wφ	: 0.65		m/m

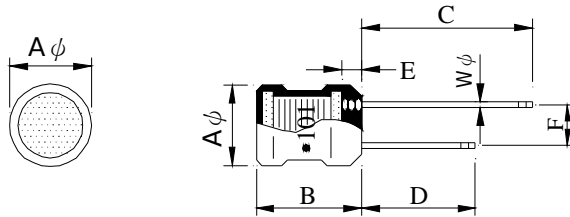

II . SCHEMATIC DIAGRAM :

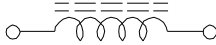

III . MATERIALS :

- a . Core : Ferrite DR core
- b . Wire : Enmelled copper wire (Class F)
- c . Lead : Sn/Ag/Cu
- d . Tube : Sheinkable tube 125°C , 600V
- e . Remark : Products comply with RoHS' requirements

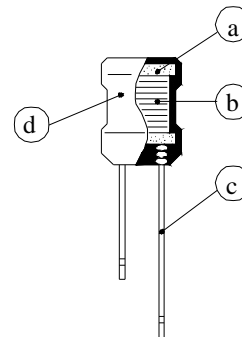

IV . GENERAL SPECIFICATION :

- a . Temp. rise : 20°C max. at rated current.
- b . Storage temp. : -25°C ---- +85°C
- c . Operating temp. : -20°C---- +80°C

AR-001A

SPECIFICATION FOR APPROVAL

REF : 20080714-B

PAGE: 2

PROD. NAME	RADIAL INDUCTOR	ABC'S DWG NO.	RB0812□□□□L□-□□□
		ABC'S ITEM NO.	

V . ELECTRICAL CHARACTERISTICS :

DWG No.	Inductance (μ H)	Q min.	Test Freq. (MHz)		SRF (MHz) min.	RDC (Ω) max.	IDC (mA) max.
			L	Q			
RB0812470KL□-□□□	47 \pm 10%	30	2.52		6.00	0.40	450
RB0812560KL□-□□□	56 \pm 10%	30	2.52		5.50	0.45	400
RB0812680KL□-□□□	68 \pm 10%	30	2.52		5.00	0.50	360
RB0812820KL□-□□□	82 \pm 10%	30	2.52		4.50	0.50	340
RB0812101KL□-□□□	100 \pm 10%	45	0.796		4.20	0.60	320
RB0812121KL□-□□□	120 \pm 10%	45	0.796		3.60	0.70	300
RB0812151KL□-□□□	150 \pm 10%	45	0.796		3.40	0.90	280
RB0812181KL□-□□□	180 \pm 10%	45	0.796		3.20	1.00	260
RB0812221KL□-□□□	220 \pm 10%	45	0.796		3.00	1.20	240
RB0812271KL□-□□□	270 \pm 10%	45	0.796		2.80	1.40	220
RB0812331KL□-□□□	330 \pm 10%	45	0.796		2.50	1.60	200
RB0812391KL□-□□□	390 \pm 10%	45	0.796		2.30	1.80	180
RB0812471KL□-□□□	470 \pm 10%	45	0.796		2.20	2.00	160
RB0812561KL□-□□□	560 \pm 10%	45	0.796		2.00	2.50	150
RB0812681KL□-□□□	680 \pm 10%	45	0.796		1.70	2.90	140
RB0812821KL□-□□□	820 \pm 10%	45	0.796		1.50	3.10	130
RB0812102KL□-□□□	1000 \pm 10%	45	0.252		1.40	3.90	120
RB0812122KL□-□□□	1200 \pm 10%	60	0.252		1.10	4.40	110
RB0812152KL□-□□□	1500 \pm 10%	60	0.252		0.90	6.00	100
RB0812182KL□-□□□	1800 \pm 10%	60	0.252		0.80	7.00	90
RB0812222KL□-□□□	2200 \pm 10%	60	0.252		0.75	8.00	80
RB0812272KL□-□□□	2700 \pm 10%	60	0.252		0.70	9.00	70
RB0812332KL□-□□□	3300 \pm 10%	60	0.252		0.60	12.00	60
RB0812392KL□-□□□	3900 \pm 10%	60	0.252		0.55	14.00	55
RB0812472KL□-□□□	4700 \pm 10%	60	0.252		0.50	16.00	50
RB0812562KL□-□□□	5600 \pm 10%	60	0.252		0.48	18.00	45
RB0812682KL□-□□□	6800 \pm 10%	60	0.252		0.44	24.00	40
RB0812822KL□-□□□	8200 \pm 10%	60	0.252		0.40	30.00	36
RB0812103KL□-□□□	10000 \pm 10%	60	0.0796		0.36	39.00	34
RB0812123KL□-□□□	12000 \pm 10%	60	0.0796		0.32	46.00	32
RB0812153KL□-□□□	15000 \pm 10%	60	0.0796		0.30	54.00	30
RB0812183KL□-□□□	18000 \pm 10%	60	0.0796		0.28	76.00	27
RB0812223KL□-□□□	22000 \pm 10%	60	0.0796		0.24	92.00	25
RB0812273KL□-□□□	27000 \pm 10%	60	0.0796		0.20	102.00	22
RB0812333KL□-□□□	33000 \pm 10%	60	0.0796		0.16	140.00	20
RB0812393KL□-□□□	39000 \pm 10%	60	0.0796		0.13	150.00	18
RB0812473KL□-□□□	47000 \pm 10%	60	0.0796		0.10	162.00	16

1). □ : Packafing information... [A] Bulk

2). "- □□□ ":Reference code

AR-001A



SPECIFICATION FOR APPROVAL

REF : 20080714-B

PAGE: 3

PROD. NAME	RADIAL INDUCTOR	ABC'S DWG NO.	RB0812□□□□L□-□□□
		ABC'S ITEM NO.	

VI . TAPED PACKAGE DIMENSIONS :

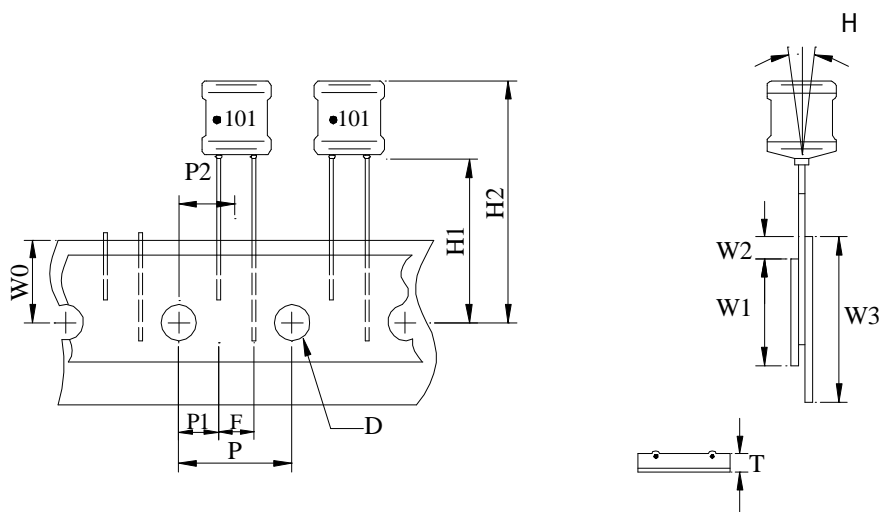

※ 500 PCS / REEL

ITEM	SYMBOL	SPECIFICATION			
		MILIMETER		INCH	
		SIZE	TOLERANCE	SIZE	TOLERANCE
TAPE FEED HOLE DIAMETER	D	4.00	±0.20	0.157	±0.008
COMPONENT LEAD PITCH	F	3.00	±0.50	0.200	±0.020
FRONT-TO-REAR DEFLECTION	H	2.00	MAX.	0.079	MAX.
FEED HOLE TO BOTTOM OF COMPONENT	H1	18.50	±0.80	0.728	±0.040
FEED HOLE TO OVERALL COMPONENT HEIGHT	H2	30.50	MAX.	1.280	MAX.
FEED HOLE PITCH	P	12.70	±0.30	0.500	±0.012
LEAD LOCATION	P1	4.85	±0.70	0.152	±0.028
CENTER OF COMPONENT LOCATION	P2	6.35	±1.30	0.250	±0.051
OVERALL TAPED PACKAGE THICKNESS	T	1.42	MAX.	0.056	MAX.
FEED HOLE LOCATION	W0	9.00	±0.50	0.354	±0.020
ADHESIVE TAPE WIDTH	W1	15.00	±0.50	0.598	±0.020
ADHESIVE TAPE POSITION	W2	4.00	MAX.	0.157	MAX.
TAPE WIDTH	W3	18.00	±0.50	0.709	±0.020

AR-001A

SPECIFICATION FOR APPROVAL

REF : 20080714-B

PAGE: 4

PROD. NAME	RADIAL INDUCTOR	ABC'S DWG NO.	RB0812□□□□L□-□□□
		ABC'S ITEM NO.	

VII . DWGING NUMBER EXPRESSION :

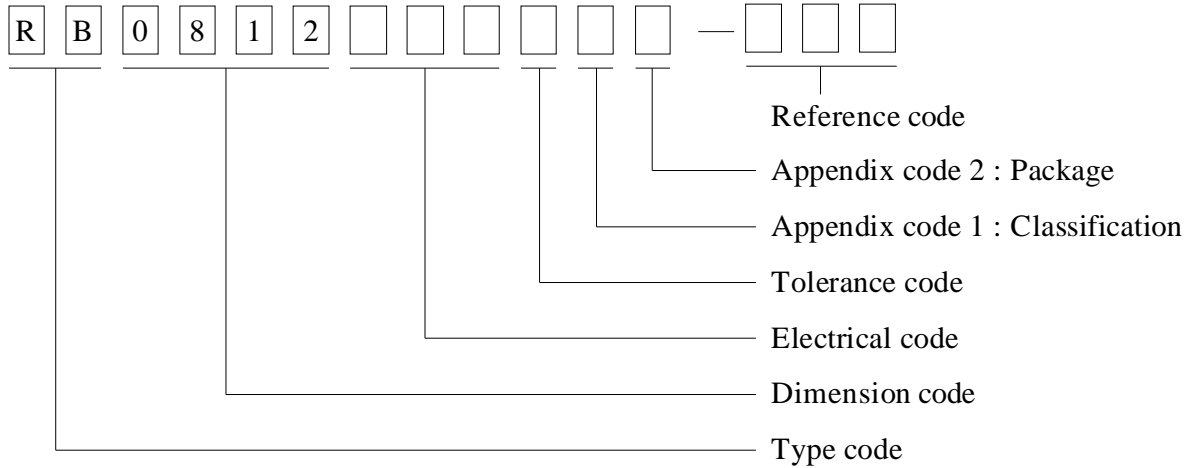

Appendix code 1 : Product Classification

L : Lead Free Standard products comply with RoHS' requirements

1 ~ 9 : Lead Free Special products comply with RoHS' requirements

Appendix code 2 : Package Information

Code	Inner package	Inner package QTY	Remark
A	Box	400 pcs	
B	Bag	200 pcs	
C	Tray	160 pcs	
D	T.B.D.	T.B.D.	
E	T / R (Reel Package)	500 pcs	

AR-001A



SPECIFICATION FOR APPROVAL

REF : 20080714-B

PAGE: 5

PROD. NAME	RADIAL INDUCTOR	ABC'S DWG NO.	RB0812□□□□L□-□□□
		ABC'S ITEM NO.	

VIII . UL CARD :

OBMW2 September 8, 2000
Magnet Wire-Component

JUNG SHING WIRE CO LTD E174837
231 CHUNG CHENG RD, SEC 3 JEN-TEH HSIANG, TAINAN
HSIEN TAIWAN

Mtl Dsg	Mark Dsg	BC	Coat Typ	OC	ANSI Type	Temp Class
AIW	---	Polyamideimide		---	MW81-C	220
CFUEWB	---	Polyurethane		---	MW75C	130
EIAIW	---	Polyesterimide		Polyamideimide	MW35C	200
EILOCKY	---	Polyesterimide		Polyamide	---	180
EILOCKW	---	Polyesterimide		Modified Epoxy	---	200
EIW	---	Polyesterimide		---	---	220
EIW-2	---	Polyesterimide		---	MW74-C	200
FL.EILOCKY	---	Modified Polyester		Polyamide	---	155
LSFFW	---	Polyurethane		---	MW79-C	155
LSUEW	---	Polyurethane		---	---	130
PEW	---	Polyester		---	---	155
PEY	---	Polyester		Nylon	MW24-C	155
SF.FLW	---	Modified Polyester		---	MW26C	155
SF.EIW	---	Polyesterimide		---	MW77C	180
SF.BY@	---	Modified Polyester		Nylon	MW27-C	155
SF.FLY@	---	Modified Polyester		Nylon	MW27-C	155
SF.BLOCKBS	---	Modified Polyester		Modified Polyamide	---	155
SF.EILOCKY#	---	Polyesterimide		Polyamide	---	180
SF.EILOCKBS	---	Polyesterimide		Modified Polyamide	---	180
SF.BW@	---	Modified Polyester		---	MW26C	155
SFFW	---	Polyurethane		---	MW79	155

A not-for-profit organization
dedicated to public safety and
committed to quality service

287806002 Page 1 of 2

Mtl Dsg	Mark Dsg	BC	Coat Typ	OC	ANSI Type	Temp Class
SAFY	---	Polyurethane		Polyamide	MW80C	155
UEW-1	---	Polyurethane		---	MW2-C	105
UEW-2	---	Polyurethane		---	---	130
UEW-4	---	Polyurethane		---	MW75C	130
UEY	---	Polyurethane		Nylon	MW28-C	130
UEY-2	---	Polyurethane		Polyamide	MW28-C	130

@ - May be suffixed by LZ; # - May be suffixed by LZ, EL or LZL.
LZ - Signifies magnd wires twisted together; EL - signifies base coated magnet wire laid parallel with top coat applied overall; LZL - signi-
fies base coated magnet wire twisted together and covered with top coat overall.

Marking: Company name or trademarks JSW or 榮星電線, material designation or marked designation on packaed or reel, and
Recognized Component Mark.

See General Information Preceding These Recognitions
For use only in equipment where the acceptability of the combination is determined by Underwriters Laboratories Inc.

287806002 Page 2 of 2 OBMW2/E174837
September 8, 2000

AR-001A

