

## PIC-M0625 Permanent Magnet

### Data

<b>Material</b>	Alnico 500	
<b>Orientation</b>	axially	
<b>Remanence Br</b>	mT	1281
<b>Coercivity HcB</b>	kA/m	50
<b>Coercivity HcJ</b>	kA/m	52
<b>Energy Product (BH) max.</b>	kJ/m <sup>3</sup>	40
<b>Magnetic Moment M</b>	x10 <sup>-5</sup> Vs cm	6.21
<b>Operating Temperature max.</b>	°C	500
<b>Curie Temperature Tc</b>	°C	890
<b>Temperature Coefficient Tk(Br)</b>	%/°C	-0.02
<b>Density</b>	g/cm <sup>3</sup>	7.3

Nominal values unless otherwise specified

### Dimensions

in mm

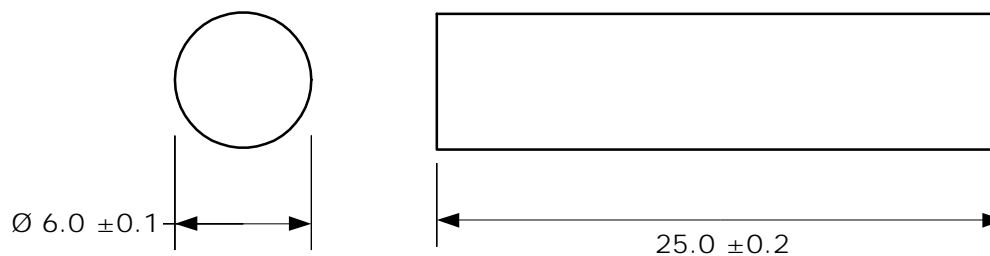

**Customized types available.**