

Specifications

Insulation Resistance: 50MΩ min. at 250V DC
 Withstanding Voltage: 250V AC for 1 minute
 Contact Resistance: 30mΩ max.
 Rating: 100V AC / 1A max or
 12V DC / 2A max.
 Operating Temp. Range: -55°C to +85°C
 Mating Cycles: 1000 min. at 10-20 times
 per minute (no electrical load)

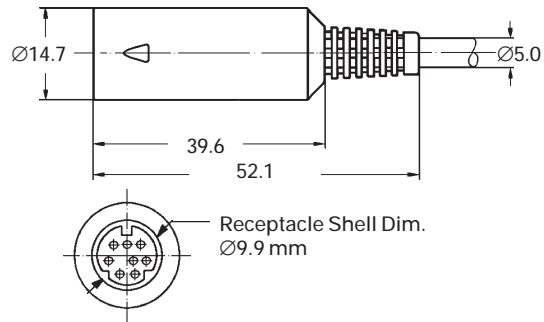

Materials and Finish

Housing: PVC
 Shell: Copper, Nickel Plated
 Insulator: PC, Nylon
 Contact: Copper, Silver plated



Features

⇨ 180° Assembled Receptacle Connector with Solder Cups

Contact Arrangements

3 Pins

Part No.: MDIN03J

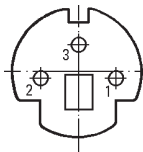

Front View

6 Pins

Part No.: MDIN06J

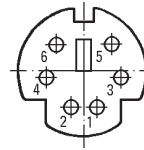

Front View

4 Pins

Part No.: MDIN04J

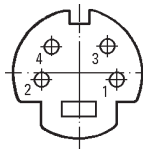

Front View

7 Pins

Part No.: MDIN07J

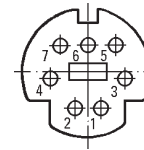

Front View

5 Pins

Part No.: MDIN05J

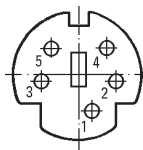

Front View

8 Pins

Part No.: MDIN08J

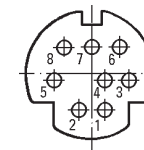

Front View