

LC503PPG1-30P

Features

5mm Package
 High Optical Power
 High Luminous Intensity
 Water Clear Lens
 All Plastic Mold Type

Applications

Outdoor Message Centers
 VMS
 Automotive Interior Lighting
 Traffic Signals
 Pedestrian Signals
 Decorative Lighting

Maximum Ratings (Ta=25°C)

| Characteristic | Symbol | Max. | Unit |
|-----------------------|------------------|----------------|------|
| Forward Current | I _F | 25 | mA |
| Reverse Voltage | V _R | 5 | V |
| Power Dissipation | P _D | 105.00 | mW |
| Operating Temperature | T _{opr} | -40 ~ +95 | °C |
| Storage Temperature | T _{stg} | -40 ~ +100 | °C |
| Soldering Temperature | T _{sol} | 260 | °C |
| Soldering Time | - | for 3 sec. max | - |

Opto-Electrical Characteristics (Ta=25°C)

| Characteristic | Symbol | Test Condition | Min | Typ | Max | Unit |
|--------------------------|-------------------|----------------------|---------|---------|------|------|
| Forward Voltage | V _F | I _F =20mA | - | 3.60 | 4.20 | V |
| Reverse Current | I _R | V _R =5V | - | - | 100 | μA |
| Luminous Intensity | I _v | I _F =20mA | 3000.00 | 4800.00 | - | mcd |
| Viewing Angle | 2θ ^{1/2} | - | - | 30° | - | deg. |
| Peak Wavelength | λ _p | I _F =20mA | - | 520 | - | nm |
| Dominant Wavelength | λ _d | I _F =20mA | - | 525 | - | nm |
| Spectral Line Half Width | Δλ | I _F =20mA | - | 38 | - | nm |

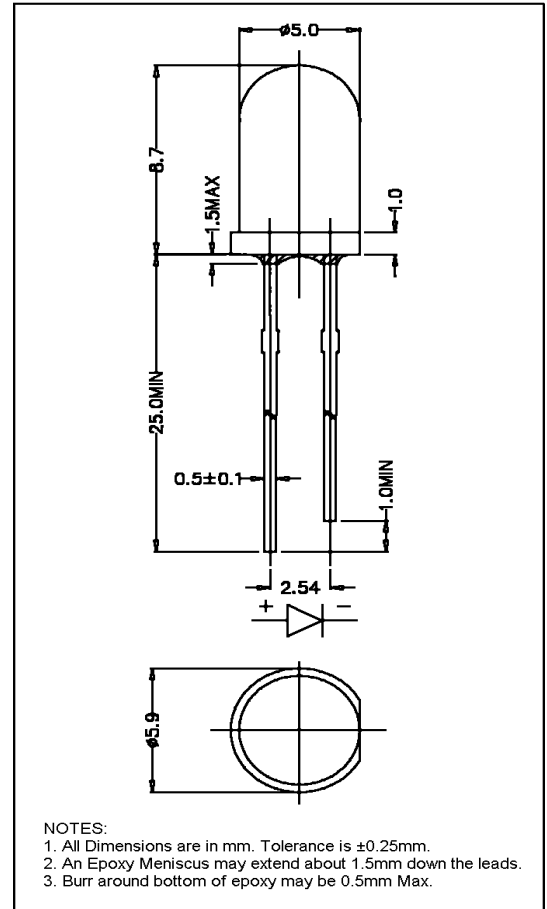

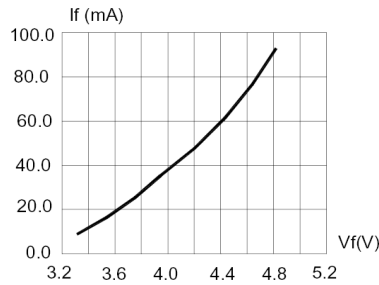

FIG.1 FORWARD CURRENT VS. FORWARD VOLTAGE.

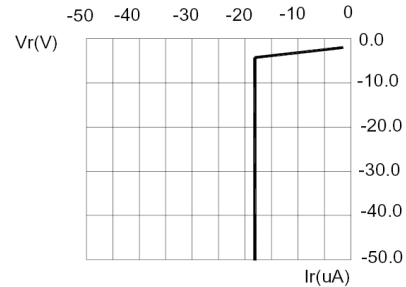

FIG.2 REVERSE CURRENT VS. REVERSE VOLTAGE.

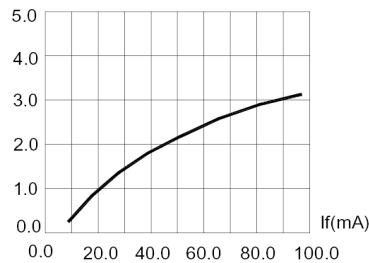

FIG.3 RELATIVE LUMINOUS INTENSITY VS. FORWARD CURRENT.

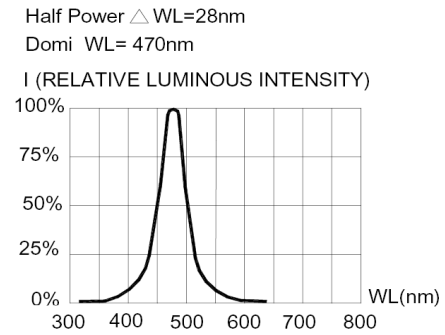

FIG.4 RELATIVE LUMINOUS INTENSITY VS. WAVELENGTH.

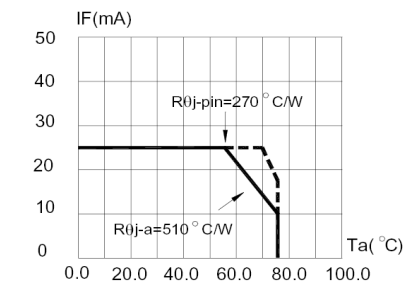

FIG.5 MAXIMUM FORWARD DC CURRENT VS AMBIENT TEMPERATURE ($T_{jmax}=95^{\circ} \text{C}$)

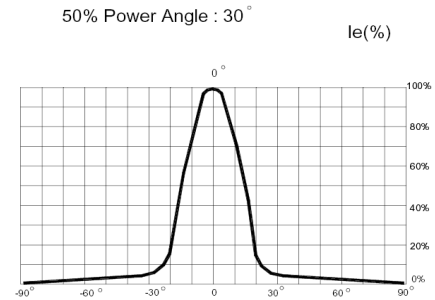

FIG.6 FAR FIELD PATTERN

1. Cathode PAD Area (0.18 X 0.18inch²)
2. Height above nominal seating plane in inches(0.3inch)