

FEATURES

- Non-Flammable
- Ribbon Winding
- Low Resistance

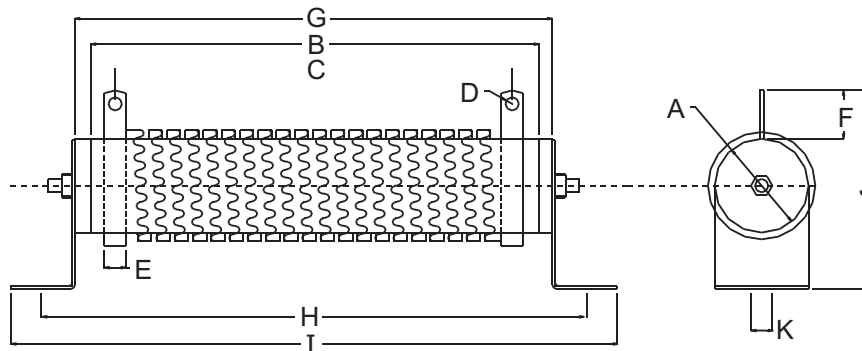

PART NUMBER EXAMPLE

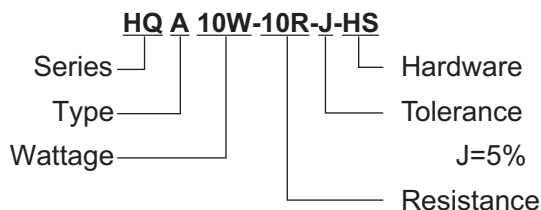

A type : Fixed Resistor
 B type : Fixed with a tap
 C type : Adjustable Tap

Hardware: HS = Screw in Bracket
 HP = Press in Bracket
 HX = Special
 Omit = No Hardware

SPECIFICATIONS

Watts Power Rating	Dimensions (m/m)											Ohms Resistance Range
	A±1	B±2	C±2	D±0.1	E±0.2	F±1	G±2	H±2	I±2	J±2	K±0.1	
75W	25	110	92	5.2	8	19	120	142	164	58	6	0.1~8
90W	28	90	72	5.2	8	17	101	123	145	60	6	0.1~9
120W	28	110	92	5.2	8	17	121	143	165	60	6	0.2~12
150W	28	140	122	5.2	8	17	151	173	195	60	6	0.2~15
180W	28	160	142	5.2	8	17	171	193	215	60	6	0.2~18
225W	28	195	177	5.2	8	17	206	229	250	60	6	0.2~20
240W	35	185	167	5.2	8	17	197	219	245	75	8	0.5~25
300W	35	210	192	5.2	8	17	222	242	270	75	8	0.5~30
375W	40	210	188	5.2	10	18	222	242	270	77	8	0.5~40
450W	40	260	238	5.2	10	18	272	292	320	77	8	0.5~45
600W	40	330	308	5.2	10	18	342	380	390	77	8	0.5~60
750W	50	330	304	6.2	12	28	346	367	399	105	9	0.5~75
900W	50	400	374	6.2	12	28	416	437	469	105	9	1~90
1000W	50	460	425	6.2	15	30	480	504	533	105	9	1~100
1200W	60	460	425	6.2	15	30	480	504	533	112	10	1~120
1500W	60	540	505	6.2	15	30	560	584	613	112	10	1~150
2000W	65	650	620	6.2	15	30	667	700	715	115	10	1~200

■ ELECTRICAL SPECIFICATION

Characteristics	Limits
Resistance and Tolerance	Resistance nominal $1\Omega > R$ Resistance Tolerance $\pm 10\%$ (K)
Temperature coefficient	$\pm 400\text{ppm}/^\circ\text{C}$ max.
Power rating load	$\Delta R/R \leq \pm 1\%$ (Temperature) 375°C max
Short-time overload	300% rated power 5 seconds $\Delta R/R \leq \pm 2\%$
Insulation resistance	500Vdc 100M Ω min
Dielectric withstanding voltage	3000Vac 1 minute

■ ELECTRICAL CURVES

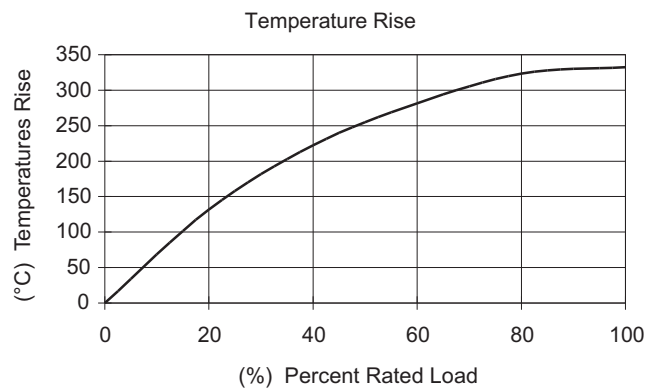
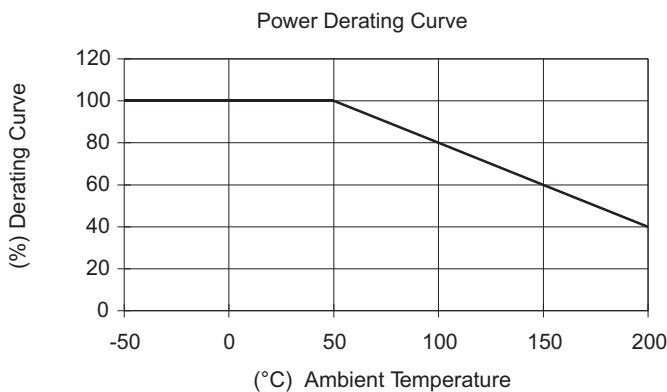

SHORT-TIME OVERLOAD RATING

(Second) Load Time	5	10	30	60	180	300	600	900	1800
(%) Max. Amps Rated load	400	350	250	200	140	120	110	105	100

NEMA STANDARD / ON-OFF CYCLING

Cycling time	5 sec ON	10 sec ON	15 sec ON	15 sec ON	15 sec ON	15 sec ON
(%)	75 sec OFF	70 sec OFF	75 sec OFF	45 sec OFF	30 sec OFF	15 sec OFF
Max. Amps Rated load	290	215	185	160	150	125