

D TYPE CONNECTORS - TURNED PIN

- 9, 15, 25, 37 or 50 way
- Turned Pin (Machined) Contact
- Gold Plated Contacts
- Yellow Zinc Metal or Tin Housings available
- Current Rating - 5Amps

PCB STRAIGHT PIN

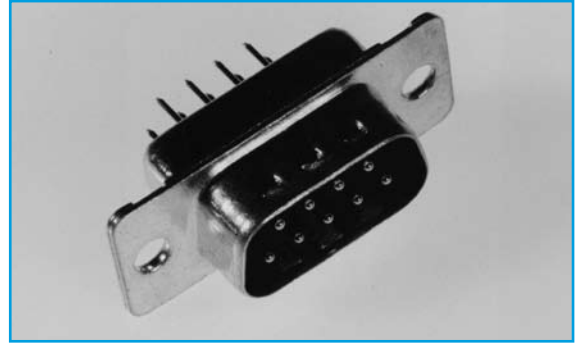

SPECIFICATION

Mechanical:

- Termination:** Hand Solder
Dip Solder straight
Dip Solder 90°C
Wire Wrap 0.6 x 0.6mm
- Polarisation:** by trapezoidal shell
- Coupling:** by friction, locking by special accessories
- Withdrawal force:** ca. 0.5 N per contact
- Material and Finishes:** Shell steel with yellow passivation over zinc plate (standard), steel nickel plated and tinned
- Insulators:** Two part mouldings, polyester, glass fibre re-enforced, flame retarded according UL 94 V0
- Contacts:** gold plated over nickel
- Insertion Cycles:** 500

Electrical:

- Creeping Current Stability:** KB 220 according to DIN 53480
- Working Current:** 5A per contact with 20AWG cable
- Working Voltages:** 300V rms
- Test Voltage:** 1000V rms
- Contact Resistance:** below $5 \times 10^{-3} \Omega$
- Insulation Resistance:** over 10M Ω
- Temperature Range:** -55°C to 125°C

SECTION 11

OUTLINE DRAWING

PANEL CUT OUT

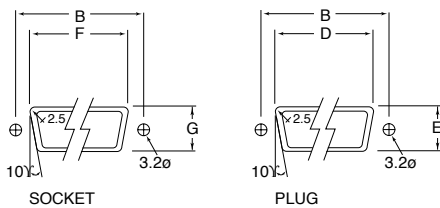

SOCKET

PLUG

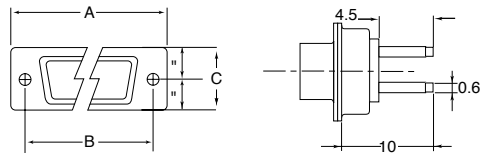

SHELL DIMENSIONS

	A	B	C	D	E	F	G
9 WAY	30.8	25.0	12.4	22.2	13.0	20.5	11.4
15 WAY	39.2	33.3	12.4	30.5	13.0	28.8	11.4
25 WAY	53.1	47.0	12.4	44.3	13.0	42.5	11.4
37 WAY	69.5	63.5	12.4	60.7	13.0	59.1	11.4
50 WAY	67	61.1	15.4	58.3	13.0	56.3	14.1

Dimension - mm

ORDERING INFORMATION

DBC

Dubilier
Connectors

TD

Series

TD = Turn Pin D

M1

Connector Type

M1=Male(plug) zinc
F 1= Female(socket) zinc
M2 = Male (plug) Tin
F2 = Female (socket) Tin

SS

Contact Style

SS = Solder Straight

09

N° of Ways

09 = 9ways
15 = 15ways
25 = 25ways
37 = 37ways
50 = 50ways

3