



## PL00284 Series SMD LED Bi-Color 1311 Package

### Features

- \*Flat Lens Package 3.3 x 2.9 x 1.1mm
- \*AlGaAs Super Bright Red and GaP Green LED Chips used
- \*Low Current Requirements
- \*High Light Output
- \*Compatible with IR Solder-Process
- \*Industry Standard Footprint
- \*For use as Optical Indicator, Backlighting
- \*2000 or 1000 pcs per Reel
- \*RoHS Compliant

### Absolute Maximum Ratings at T<sub>A</sub> = 25°C

Power Dissipation (Red).....	72mW
Power Dissipation (Green).....	65mW
Reverse Voltage (<100 mA).....	5.0V
Max Forward Current (Red).....	30mA
Max Forward Current (Green).....	25mA
Peak Forward Current (1/10 Duty Cycle, 0.1ms Pulse Width).....	100mA
Operating Temperature Range.....	-40°C to +85°C
Storage Temperature Range.....	-40°C to +85°C
Reflow Soldering Temperature.....	260°C for 10 seconds

### Electrical & Optical Characteristics at T<sub>A</sub> = 25°C

Part Number	Emitting Color	Chip Material	Peak Wave Length	Dominant Wave Length	Viewing Angle 2θ ½	Forward Voltage @20mA (V)		Luminous Intensity @20mA (mcd)	
						Typ	Max	Min	Typ
	Water Clear Lens		nm	nm	Deg				
PL00284-WCRG2113	Deep Red Green	AlGaAs GaP	660 568	645 570	120°	1.85 2.2	2.4 2.6	18.0 5.0	40.0 12.0

All dimensions are in **Millimeters**. Tolerance is ± 0.25mm unless otherwise specified.

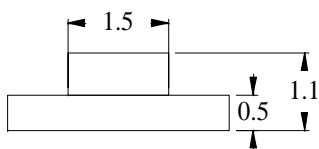
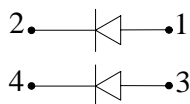
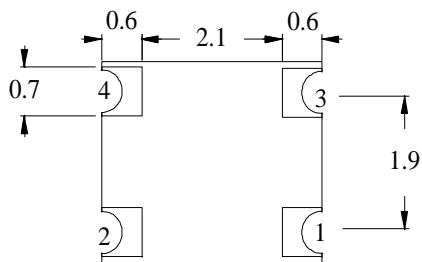
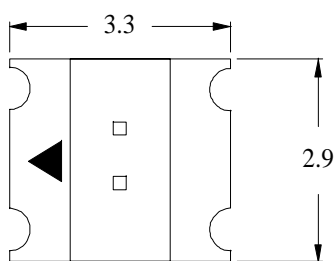

### Recommended Soldering Pad Layout

