

Surface Mount LED J Series for low current or superbright use, 0128 Series Right Angle Lens

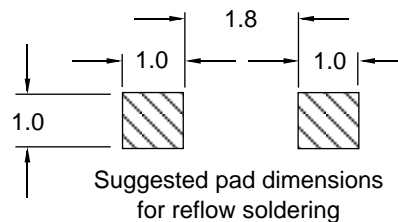

The 0128 series lamps are miniature chip type designed for two-way surface mounting. Mounted normally, these lamps can be used as circuit board status indicators or as backlight for switches or key pads. Mounted at right angles these lamps are miniature through the panel indicators. These lamps are in EIA481 tape and reel packaging with approximately 2000 pcs per reel.

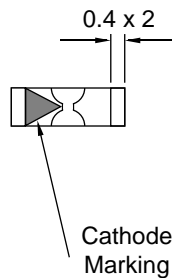
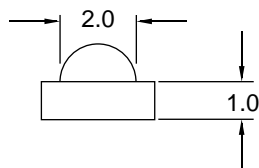
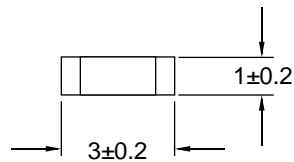

RoHS Compliant
Aug 2004

GENERAL INFORMATION

Operating Temperature Range	-40 °C to +85 °C
Storage Temperature Range	-40 °C to +90 °C
Reflow Soldering Temperature	260 °C for 5 sec max

APPLICATION INFORMATION (ALL RATINGS AT 25 °C AMBIENT)

Part No.	Emitted Color	Peak	$\Delta\lambda$	Absolute Maximum Ratings					E/O Characteristics					
		λ		Pd	If (mA)		Ir	Vr	Iv (mcd) @ If=20mA			Vf (V) @ If=20mA		$2\Theta_{1/2}$
		(nm)			(mW)	dc			1/10 duty @ 1 kHz	@ Vr=5V (μ A)	(V)	2mA	Min	
JRC0128	Red	632	20	60	25	160	10	5	3	19	47	2.0	2.4	120
JGC0128	Green	575	20	60	25	160	10	5	1	13	19	2.0	2.4	120
JYC0128	Yellow	591	15	60	25	160	10	5	3	19	48	2.0	2.4	120
JOC0128	Orange	621	18	60	25	160	10	5	3	19	48	2.0	2.4	120
JEC0128	OrRed	639	20	60	25	160	10	5	2	18	38	2.0	2.4	120
JYOC0128	YelOrng	611	17	60	25	160	10	5	3	19	48	2.0	2.4	120

Specifications subject to change without notice. Dimensions are in mm±0.3 unless stated otherwise.

IDEA, Inc., 1351 Titan Way, Brea, CA 92821 Ph:714-525-3302, 800-LED-IDEA; Fax: 714-525-3304 0508

013S-J0128