

# AS85049/85, AS85049/86, and AS85049/87 Banding Backshells

## Glenair Connector Designator F

MIL-DTL-38999 Series I & II,  
40M38277, PAN 6433-1, PATT  
614, PATT 616,  
NFC93422 Series HE308 &  
HE309

### M85049/85-16 P 02

Basic Part No.:

M85049/85 = Straight  
M85049/86 = 45°  
M85049/87 = 90°

Shell Size

Entry Size

Finish

N = Electroless Nickel  
P = Cadmium Olive Drab over  
Electroless Nickel with  
Polysulfide Sealant Strips  
W = 1,000 Hour Cadmium Olive  
Drab Over Electroless Nickel

## Self Locking Coupling

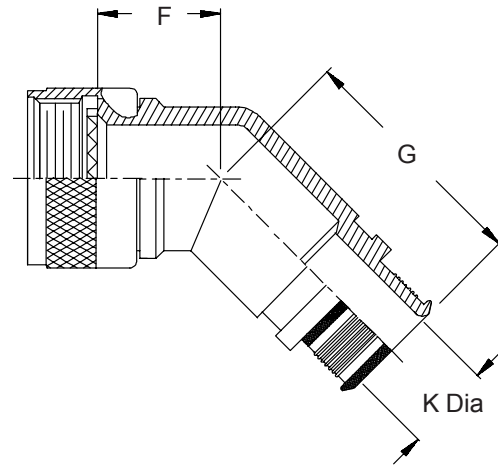
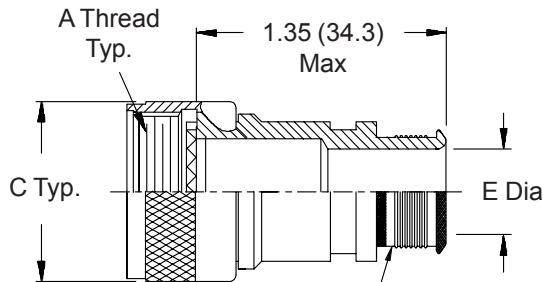

### P Finish Option (Typ.)

Band Term. Area  
Free of Cadmium,  
Knurl or Ridges  
Mfr's Option

Polysulfide Strips

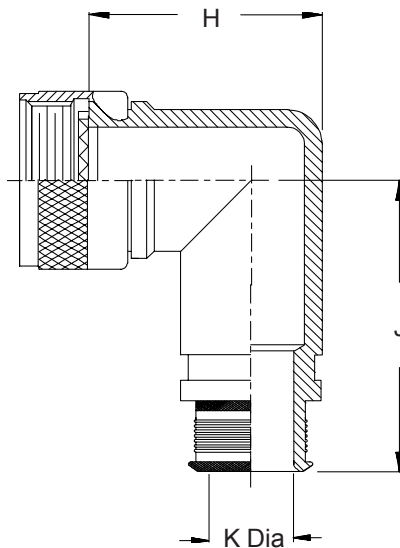

# AS85049/85, AS85049/86, and AS85049/87 Banding Backshells



Crimp Ring  
and Banding  
Backshells

**TABLE I**

Shell Size	A Thread Class 2B	C Dia Max	F Max	G Max	H Max	J Max
08	.438 - 28 UNEF	.86 (21.8)	.87 (22.1)	1.16 (29.5)	1.375 (34.9)	1.417 (36.0)
10	.562 - 24 UNEF	.99 (25.1)	.90 (22.9)	1.19 (30.2)	1.437 (36.5)	1.480 (37.6)
12	.688 - 24 UNEF	1.16 (29.5)	.92 (23.4)	1.21 (30.7)	1.562 (39.7)	1.553 (39.4)
14	.813 - 20 UNEF	1.28 (32.5)	.95 (24.1)	1.24 (31.5)	1.687 (42.8)	1.614 (41.0)
16	.938 - 20 UNEF	1.41 (35.8)	.98 (24.9)	1.26 (32.0)	1.750 (44.5)	1.678 (42.6)
18	1.063 - 18 UNEF	1.52 (38.6)	.98 (24.9)	1.27 (32.3)	1.875 (47.6)	1.733 (44.0)
20	1.188 - 18 UNEF	1.64 (41.7)	1.01 (25.7)	1.30 (33.0)	1.938 (49.2)	1.796 (45.6)
22	1.313 - 18 UNEF	1.77 (45.0)	1.04 (26.4)	1.33 (33.8)	2.062 (52.4)	1.859 (47.2)
24	1.438 - 18 UNEF	1.89 (48.0)	1.07 (27.2)	1.35 (34.3)	2.125 (54.0)	1.919 (48.7)

**TABLE II - Straight Only**

Shell Size	E Dia	
	Entry Size 01 ±.010 (.3)	Entry Size 02 ±.010 (.3)
08	N/A	.250 (6.4)
10	N/A	.312 (7.9)
12	.312 (7.9)	.438 (11.1)
14	.438 (11.1)	.562 (14.3)
16	.500 (12.7)	.625 (15.9)
18	.625 (15.9)	.750 (19.1)
20	.625 (15.9)	.812 (20.6)
22	.688 (17.5)	.938 (23.8)
24	.750 (19.1)	1.000 (25.4)

**TABLE III - 45° and 90° Only**

Shell Size	K Dia	
	Entry Size 02 ±.010 (.3)	Entry Size 03 ±.010 (.3)
08	N/A	.250 (6.4)
10	N/A	.312 (7.9)
12	.312 (7.9)	.438 (11.1)
14	.438 (11.1)	.562 (14.3)
16	.500 (12.7)	.625 (15.9)
18	.625 (15.9)	.750 (19.1)
20	.625 (15.9)	.812 (20.6)
22	.688 (17.5)	.938 (23.8)
24	.750 (19.1)	1.000 (25.4)

1. For complete dimensions see applicable Military Specification.
2. Metric dimensions (mm) are indicated in parentheses.