

MD PRO

Normally closed proportional solenoid valve

FEATURES

- 2-way normally closed
- Offers automated calibration
- Provides repeatability across its operating range
- Offers a superior combination of value and performance
- Rated for 10 million life cycles



MEDIA COMPATIBILITY

Air, argon, helium, hydrogen, methane, nitrogen, oxygen & others

ELECTRICAL

Power max. 2 W
Voltage max. 5.5, 8, 11.5, 13.5, 20 or 29 V_{DC}

PHYSICAL PROPERTIES

| | |
|--------------------------|---|
| Operating environment | 0 to 60 °C |
| Storage temperature | -40 to 70 °C |
| Length | 45.3 mm (1.785 in) |
| Width | 16.5 mm (0.625 in) |
| Height | 17 mm (0.67 in) |
| Porting | 1/8" barbs; manifold mount with 43 µm screen |
| Weight | 63 g (2.2 oz) |
| Internal volume | 0.508 cm ³ (0.031 in ³) |
| Filtration (recommended) | 43 µm |
| Lubrication | None required |
| Oxygen clean | Available on special request |

MD PRO

Normally closed proportional solenoid valve

PERFORMANCE CHARACTERISTICS

| Part no. | Pressure | Vacuum | Orifice sizes | Leak rate ¹ | Response |
|-----------|--------------|----------------------------|------------------|--|---------------------|
| MDPRO4... | 0...75 psid | 0...27 "Hg (0...13 psi) | 0.040" (1.02 mm) | ≤0.22 sccm of air (bubble tight) | <30 msec cycling |
| MDPRO5... | 0...100 psid | | 0.050" (1.27 mm) | | |
| MDPRO6... | 0...50 psid | | 0.065" (1.65 mm) | | |

FLOW CURVE²

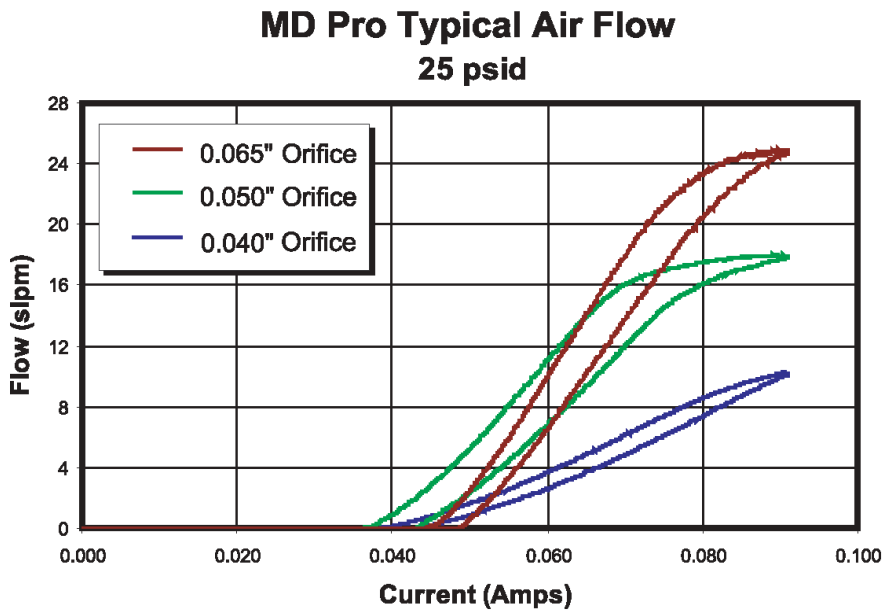

Notes:

¹ sccm denotes Standard Cubic Centimeters per Minute. It is a unit for the flow rate at standard conditions of temperature and pressure. 1000 sccm = 1 slpm.

² slpm denotes Standard Liters per Minute. It is a unit for the flow rate at standard conditions of temperature and pressure. 1 slpm = 1000 sccm.

MD PRO

Normally closed proportional solenoid valve

OUTLINE DRAWING

Basic valve dimensions

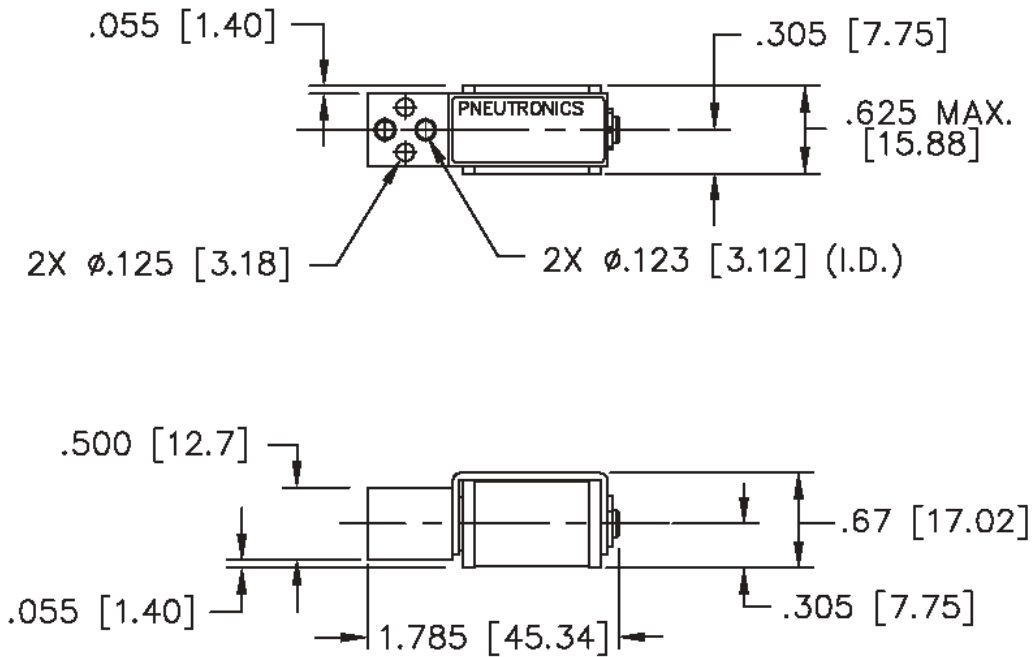

Port and mounting hole diagrams

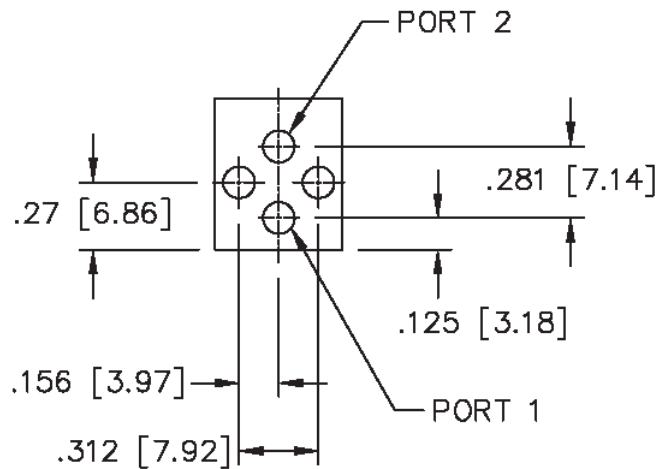

dimensions in inches (mm)

MD PRO

Normally closed proportional solenoid valve

ELECTRICAL INTERFACE OPTIONS

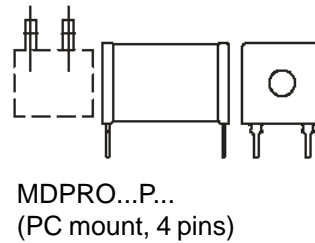
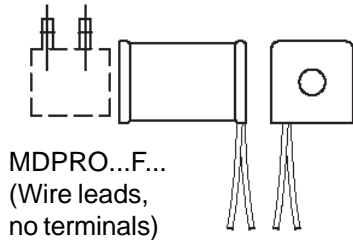

PNEUMATIC INTERFACE OPTIONS

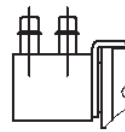
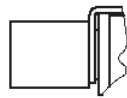

ORDERING INFORMATION

| Options | Series | Model no. | | Elastomer | Coil selection | | | Electrical interface | Pneumatic interface | | Cleaning | | | | | |
|------------------|--------|---------------|----------------------|----------------------|----------------|---|----------------------|----------------------|-------------------------|---|---|------------------------------|--|---|---|---|
| | | Max. pressure | Orifice size | | Max. voltage* | Resistance** | Current*** | | | | S: | O: | | | | |
| | MDPRO | 4: | 75 psid | 0.040" (1.016 mm) | V: FKM | A: | 5.5 V _{DC} | 11 Ω | 0.304 A | F: wire leads, 18" P: PC board mount | 1: | manifold mount with screens* | S: standard cleaning O: oxygen service* | | | |
| | | 5: | 100 psid | 0.050" (1.270 mm) | | B: | 8 V _{DC} | 23 Ω | 0.212 A | | 8: | 1/8" barbs | | | | |
| | | 6: | 50 psid | 0.065" (1.651 mm) | | C: | 11.5 V _{DC} | 47 Ω | 0.152 A | | | | | | | |
| | | D: | 13.5 V _{DC} | 68 Ω | | 0.125 A | | | | | | | | | | |
| | | E: | 20 V _{DC} | 136 Ω | | 0.091 A | | | | | | | | | | |
| | | F: | 29 V _{DC} | 274 Ω | | 0.066 A | | | | | | | | | | |
| | | | | | | * max. voltage for continuous full flow, ambient temp. 55°C ** coil resistance for room temp. *** input current for full flow | | | * 43 μm screen (port 2) | | * this option will affect price; contact Sensortech for details | | | | | |
| Example: MDPRO 4 | | | | | | | | | | | | V | A | F | 8 | S |

Note: Not all combinations might be available. Please contact your nearest Sensortech sales representative for further information.

Sensortech reserves the right to make changes to any products herein. Sensortech does not assume any liability arising out of the application or use of any product or circuit described herein, neither does it convey any license under its patent rights nor the rights of others.