

UNCONTROLLED DOCUMENT

PART NUMBER
SSB-COB6527GW

REV.
A

| REV. | E.C.N. NUMBER AND REVISION COMMENTS | DATE |
|------|-------------------------------------|---------|
| A | E.C.N. #11442 | 9.12.07 |

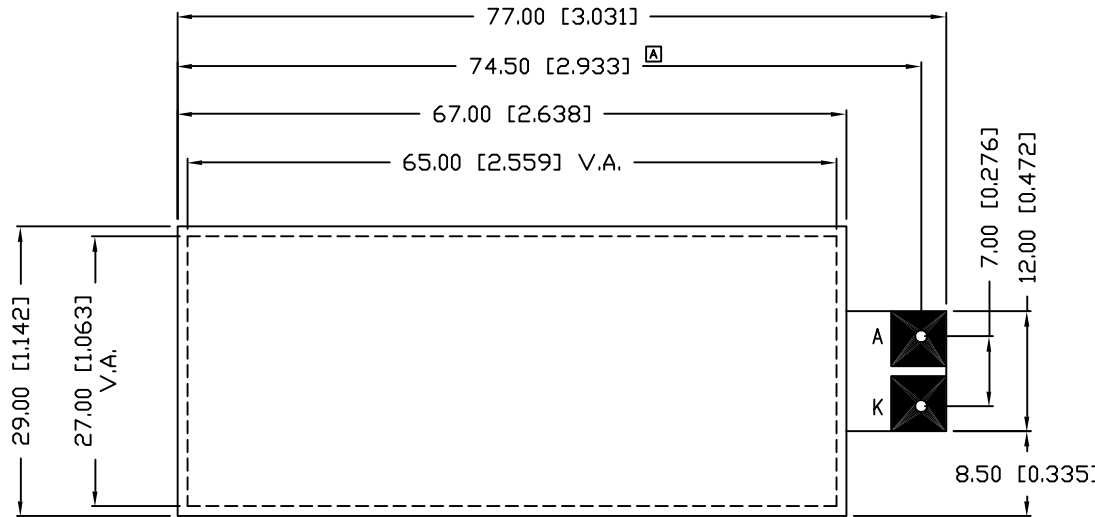

ELECTRO-OPTICAL CHARACTERISTICS $T_A=25^\circ\text{C}$ PER MODULE $I_f=220\text{mA}$

| PARAMETER | MIN | TYP | MAX | UNITS | TEST COND |
|--------------------|-------|-----|-----|------------------------|--------------------|
| PEAK WAVELENGTH | | 565 | | nm | |
| FORWARD VOLTAGE | | 4.2 | 4.5 | V_f | |
| REVERSE VOLTAGE | 8 | | | V_r | $I_f=2.2\text{mA}$ |
| LUMINOUS INTENSITY | | 300 | | cd/m^2 | $I_f=220\text{mA}$ |
| EMITTED COLOR: | GREEN | | | | |
| REFLECTOR FINISH: | WHITE | | | | |

LIMITS OF SAFE OPERATION AT 25°C PER MODULE

| PARAMETER | MAX | UNITS |
|--|------------|----------------------------|
| STEADY CURRENT | 352 | mA |
| POWER DISSIPATION | 1.58 | W |
| DERATE FROM 25°C , PER DIE | -1.2 | $\text{mW}/^\circ\text{C}$ |
| OPERATING, STORAGE TEMP. | -40 TO +85 | $^\circ\text{C}$ |
| SOLDERING TEMP. | +260 | $^\circ\text{C}$ |
| 2.0mm FROM BODY | | 3 SEC. MAX |

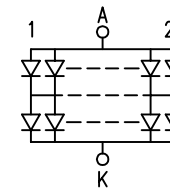
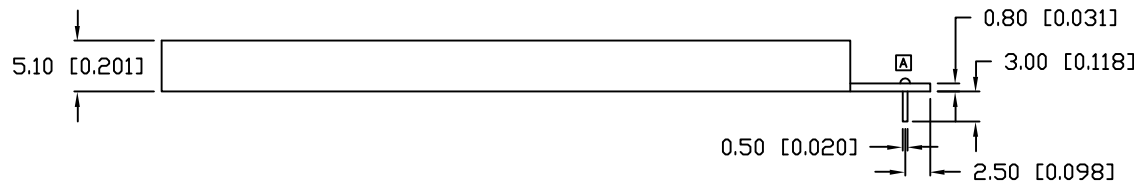

2 CHIPS IN SERIES
22 PARALLEL BRANCHES

UNCONTROLLED DOCUMENT

*UNLESS OTHERWISE SPECIFIED TOLERANCES PER DECIMAL PRECISION ARE: X=±1 (±0.039), X.X=±0.5 (±0.020), X.XX=±0.25 (±0.010), X.XXX=±0.127 (±0.005). LEAD SIZE=±0.05 (±0.002), LEAD LENGTH=±0.75 (±0.030). MIN.=+DECIMAL PRECISION MAX.=+0.00 -DECIMAL PRECISION

| | |
|---|------------------------------|
| REV. A | PART NUMBER SSB-COB6527GW |
| 65mm x 27mm VIEW AREA, CHIP ON BOARD LED BACKLIGHT, 565nm GREEN CHIPS, 44 CHIPS, 4.2V @ 220mA. | |

CONFIDENTIAL INFORMATION
THE INFORMATION CONTAINED IN THIS DOCUMENT IS THE PROPERTY OF LUMEX INC. EXCEPT AS SPECIFICALLY AUTHORIZED IN WRITING BY LUMEX INC., THE HOLDER OF THIS DOCUMENT SHALL KEEP ALL INFORMATION CONTAINED HEREIN CONFIDENTIAL AND SHALL PROTECT SAME IN WHOLE OR IN PART FROM DISCLOSURE AND DISSEMINATION TO ALL THIRD PARTIES.

RELIABILITY NOTE
OUR MANY YEARS OF EXPERIENCE DATA ACCUMULATION INDICATE THAT SOLDER HEAT IS A MAJOR CAUSE OF EARLY AND FUTURE FAILURE. PLEASE PAY ATTENTION TO YOUR SOLDERING PROCESS.

LUMEX
We have Answers to Your Problems

DRAWN BY: BC
CHECKED BY:
APPROVED BY:

290 E. HELEN ROAD
PALATINE, IL 60067-6976
PHONE: +1.847.359.2790
US WEB: www.lumex.com
TW WEB: www.lumex.com.tw

DATE: 7.1.04
PAGE: 1 OF 1
SCALE: N/A