

- ▶ 5 x 7 Footprint
- ▶ 2 Pole Filter
- ▶ Tape & Reel Packaging



ECS-96SMF 21.4 MHz

SMD CRYSTAL FILTER

The ECS-96SMF 21.400 MHz Miniature SMD Monolithic Crystal Filters offer a narrow bandwidth and a 2 pole response in a 5 x 7 package.

OPERATING CONDITIONS / ELECTRICAL CHARACTERISTICS

PART NUMBER *	CENTER FREQUENCY F ₀	PASSBAND MIN.		STOPBAND MAX.		ATTENUATION GUARANTEED MIN.		RIPPLE MAX.	LOSS MAX.	TERMINATING IMPEDANCE	OPERATING TEMPERATURE	NO. OF POLES
	MHz	dB	KHz	dB	KHz	dB	KHz	dB	dB	Ω/pF	°C	
ECS-96SMF21A7.5	21.400	3	± 3.75	20	± 18.0	70	-910	1.0	2.0	850//6.0	-30 ~ +80	2
ECS-96SMF21A15	21.400	3	± 7.5	18	± 25.0	70	-910	1.0	2.0	1500//1.5	-30 ~ +80	2
ECS-96SMF21A20	21.400	3	± 10	10	± 30.0	70	-910	1.0	2.0	1800//1.0	-30 ~ +80	2
ECS-96SMF21A30	21.400	3	± 15	15	± 45.0	70	-910	1.0	2.0	2000//0.5	-30 ~ +80	2

PACKAGE DIMENSIONS (mm)

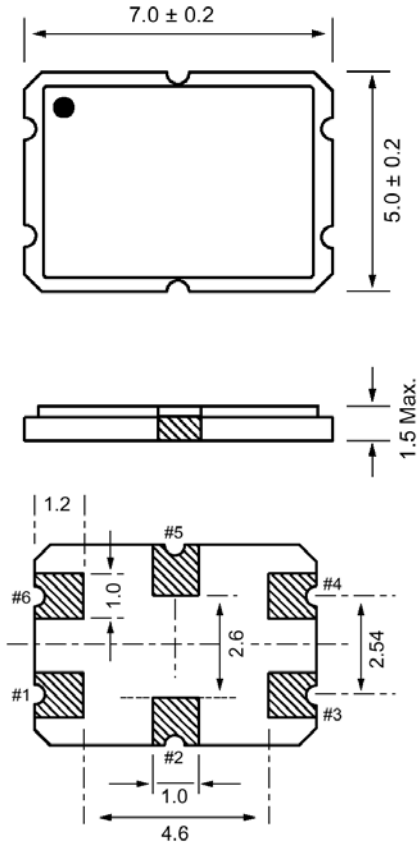

PIN CONNECTIONS	
#1	In/Out
#2	Ground
#3	Ground
#4	Out/In
#5	Ground
#6	Ground

Figure 1) Top, Side and Bottom Views

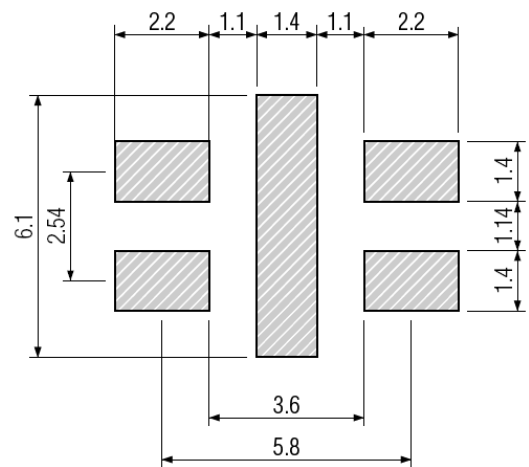

Figure 2) Land Pattern