

1. MODEL NUMBER

| MODEL NUMBER. | CUSTOMER PART NO. |
|---------------|-------------------|
| DF1495S36B    |                   |

2. TEST CONDITION

2-1 TYPICAL CONDITION : -TEMPERATURE : 20°C

-HUMIDITY : 65%RH

2-2 STANDARD CONDITION : -TEMPERATURE : -40°C to 85°C

-HUMIDITY : 45%RH to 85%RH

3. COMPOSITION AND MATERIAL

| NO. | NAME                | COMPOSITION AND MATERIALS |
|-----|---------------------|---------------------------|
| 3-1 | RESONATOR           | DIELECTRIC MATERIALS      |
| 3-2 | NUMBER OF POLE      | 2 POLE                    |
| 3-3 | IN/OUTPUT TERMINALS | Ag or Sn PLATED           |
| 3-4 | GROUND BASE         | Ag or Sn PLATED           |

4. ELECTRICAL SPECIFICATIONS

| NO. | ITEM                            | SPECIFICATIONS       |
|-----|---------------------------------|----------------------|
| 4-1 | CENTER FREQUENCY( $f_0$ )       | 1495.0MHz            |
| 4-2 | BAND WIDTH                      | $\pm 18.0$ MHz       |
| 4-3 | INSERTION LOSS IN BW            | 2.5dB max.           |
| 4-4 | RIPPLE                          | 0.5dB max.           |
| 4-5 | V.S.W.R IN BW                   | 1.5 max.             |
| 4-6 | ATTENUATION                     | 30dB min. at 1215MHz |
| 4-7 | INPUT POWER                     | 1 W                  |
| 4-8 | NOMINAL CHARACTERISIC IMPEDANCE | 50 $\Omega$          |

|  |   |             |            |      |
|--|---|-------------|------------|------|
|  | <b>SIPAT Co., Ltd.</b><br>( CETC No. 26 Research Institute )<br>Nanping Huayuan Road No. 14<br>Chongqing, China, 400060 | Part Number | DF1495S36B |      |
|  |   | Rev. Date   | 2005-9-21  |      |
|  |   | Rev.        | 1.0        | Page |

5. APPEARANCES AND DIMENSIONS

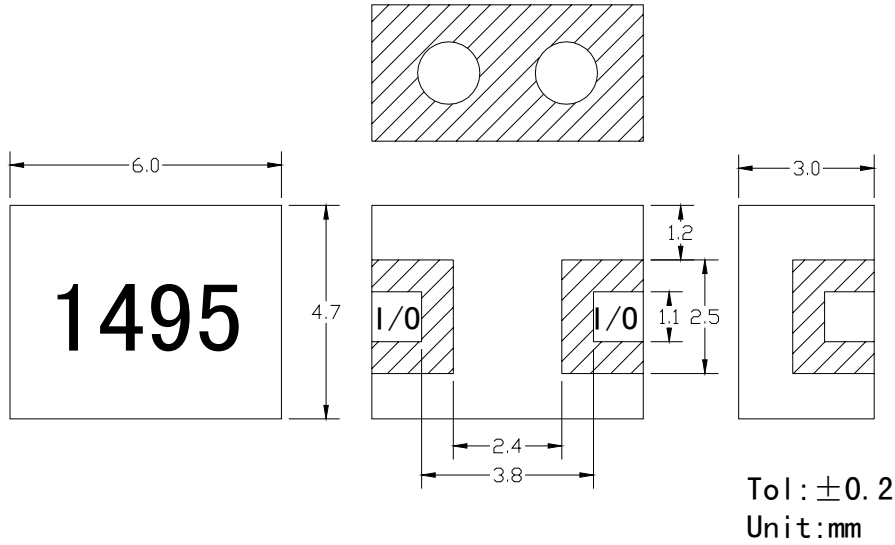

6. RECOMMENDED REFLOW PAD

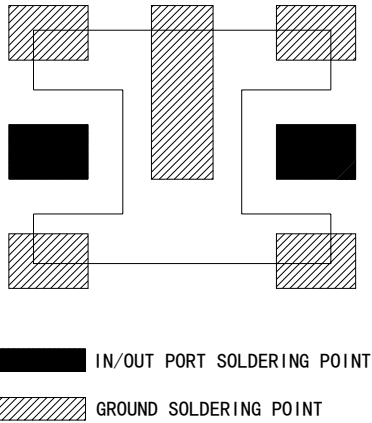

7. REFLOW SOLDERING STANDARD CONDITIONS

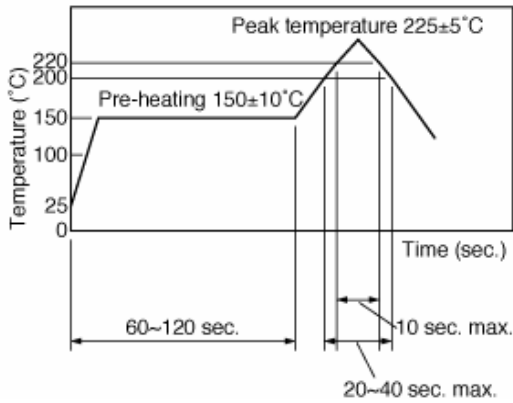

**SIPAT Co., Ltd.**  
( CETC No. 26 Research Institute )  
Nanping Huayuan Road No. 14  
Chongqing, China, 400060

|             |            |          |
|-------------|------------|----------|
| Part Number | DF1495S36B |          |
| Rev. Date   | 2005-9-21  |          |
| Rev.        | 1.0        | Page 2/3 |

8.CHARACTERISTICS

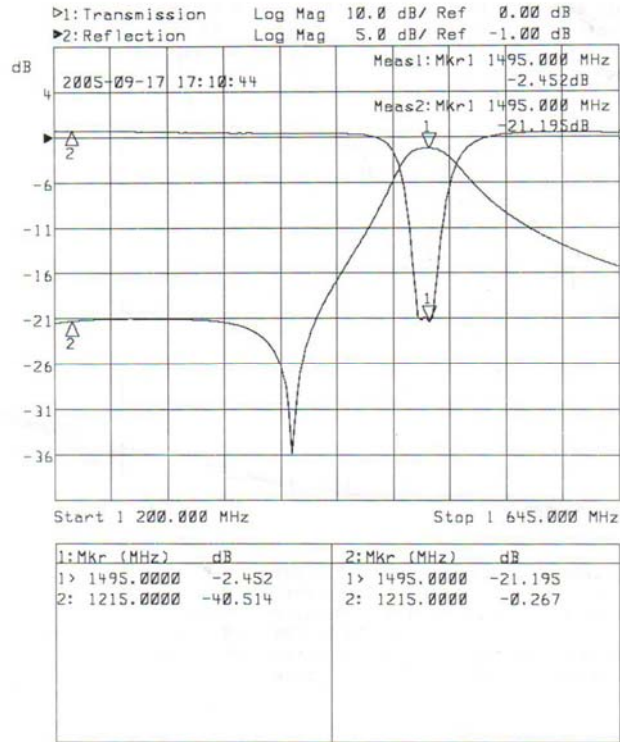
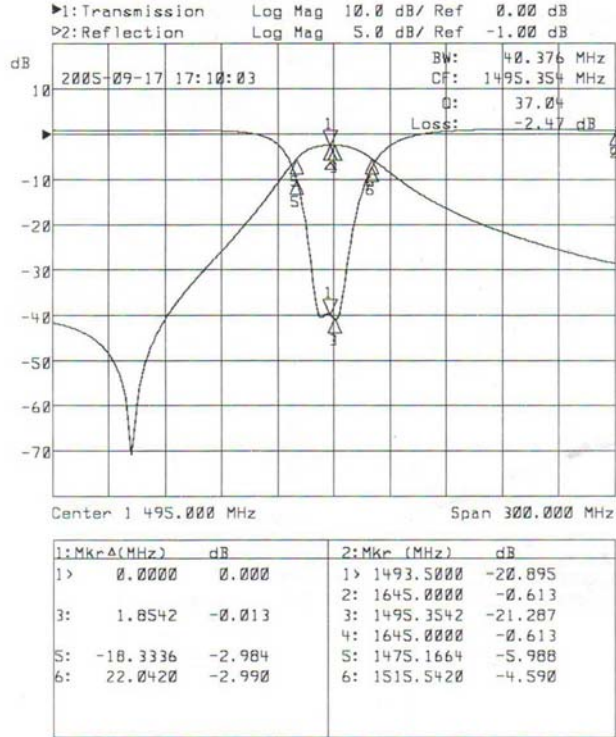

**SIPAT Co., Ltd.**  
( CETC No. 26 Research Institute )  
Nanping Huayuan Road No. 14  
Chongqing, China, 400060

|             |            |          |
|-------------|------------|----------|
| Part Number | DF1495S36B |          |
| Rev. Date   | 2005-9-21  |          |
| Rev.        | 1.0        | Page 3/3 |