

M34553T-PTCB

Converter Board for 48-pin 0.5-mm-pitch LQFP for M34552T2-CPE
(for 4553 Group)

Function

M34553T-PTCB is a converter board for 4553 Group for connecting the tip of M34553T-PTCA (50-pin Narrow-Pitch Connector Converter Board for 4553 and 4556 Groups) for M34552T2-CPE to the footpattern for 48-pin 0.5-mm-pitch QFP (48P6Q-A).

Attaching Procedure

When debugging

- (1) Mount NQPACK048SD on the foot pattern on the target system.
- (2) On the top of (1), mount YQPACK048SD.
- (3) Screw down the YQPACK048SD with YQ-GUIDE's.
- (4) Connect the YQPACK048SD and M34553T-PTCB.
- (5) Connect the M34553T-PTCA (50-pin Narrow-Pitch Connector Converter Board for 4553 and 4556 Groups) for M34552T2-CPE to the upper narrow-pitch connector of M34553T-PTCB for use.

During board-mounted evaluation

Mount the HQPACK048SD (separately available) in that order on the NQPACK048SD on the target system.

External View and Dimensions

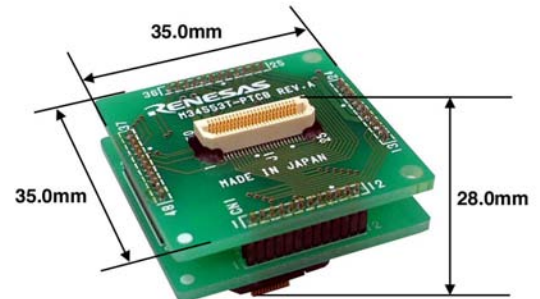

《Side View》

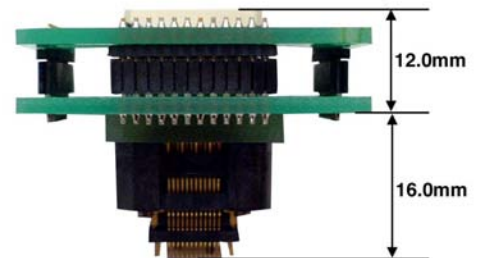

Package Components

- M34553T-PTCB converter
- YQPACK048SD (made by Tokyo Eletech Co., Ltd.)
- NQPACK048SD (made by Tokyo Eletech Co., Ltd.)
- YQ-GUIDE (× 4)
- User's manual

*Required components to connect to the target system are included with this product package. Each component made by Tokyo Eletech Co., Ltd. is optionally available alone from Tokyo Eletech Co., Ltd. See Appendix G "Contact Addresses for Partner Products".

Recommended Foot Pattern (Unit: mm)

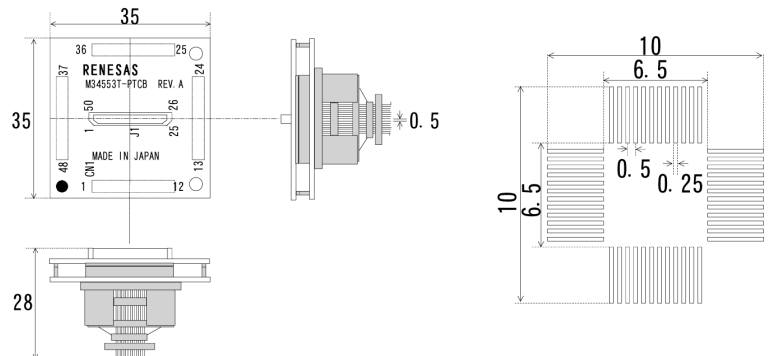
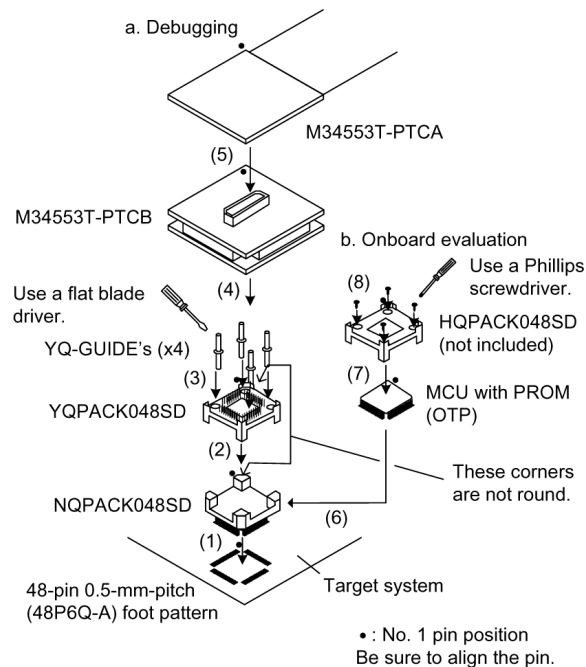

[Ordering Information] See Appendix H "Ordering Information".