

SEMiX 202GB128D

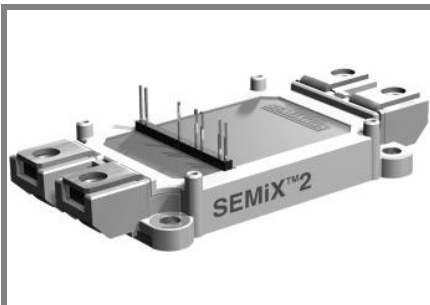

SEMiX[®] 2

SPT IGBT Modules

SEMiX 202GB128D

Preliminary Data

Features

- Homogeneous Si
- SPT = Soft-Punch-Through technology
- $V_{CE(sat)}$ with positive temperature coefficient
- High short circuit capability

Typical Applications

- AC inverter drives
- UPS
- Electronic welders up to 20 kHz

Remarks

- Not for new design



GB

Absolute Maximum Ratings		$T_{case} = 25^{\circ}C$, unless otherwise specified		
Symbol	Conditions	Values		Units
IGBT				
V_{CES}	$T_j = 25^{\circ}C$	1200		V
I_C	$T_j = 150^{\circ}C$	$T_{case} = 25^{\circ}C$	200	A
		$T_{case} = 80^{\circ}C$	140	A
I_{CRM}	$I_{CRM} = 2 \times I_{Cnom}$	200		A
V_{GES}		± 20		V
t_{psc}	$V_{CC} = 600 V$; $V_{GE} \leq 20 V$; $T_j = 125^{\circ}C$ $V_{CES} < 1200 V$	10		μs
Inverse Diode				
I_F	$T_j = 150^{\circ}C$	$T_{case} = 25^{\circ}C$	170	A
		$T_{case} = 80^{\circ}C$	120	A
I_{FRM}	$I_{FRM} = 2 \times I_{Fnom}$	200		A
I_{FSM}	$t_p = 10 ms$; sin.	$T_j = 25^{\circ}C$	1000	A
Module				
$I_{t(RMS)}$		600		A
T_{vj}		-40 ... +150		$^{\circ}C$
T_{stg}		-40 ... +125		$^{\circ}C$
V_{isol}	AC, 1 min.	4000		V

Characteristics		$T_{case} = 25^{\circ}C$, unless otherwise specified			
Symbol	Conditions	min.	typ.	max.	Units
IGBT					
$V_{GE(th)}$	$V_{GE} = V_{CE}$, $I_C = 4 mA$	4,5	5	6,5	V
I_{CES}	$V_{GE} = 0 V$, $V_{CE} = V_{CES}$			0,3	mA
V_{CE0}		$T_j = 25^{\circ}C$	1	1,15	V
		$T_j = 125^{\circ}C$	0,9	1,05	V
r_{CE}	$V_{GE} = 15 V$	$T_j = 25^{\circ}C$	9	12	m Ω
		$T_j = 125^{\circ}C$	12	15	m Ω
$V_{CE(sat)}$	$I_{Cnom} = 100 A$, $V_{GE} = 15 V$	$T_j = 25^{\circ}C_{chiplev.}$	1,9	2,35	V
		$T_j = 125^{\circ}C_{chiplev.}$	2,1	2,55	V
C_{ies}	$V_{CE} = 25$, $V_{GE} = 0 V$	$f = 1 MHz$	8,9		nF
C_{oes}			0,66		nF
C_{res}			0,42		nF
Q_G	$V_{GE} = -8 V \dots +15 V$		960		nC
$t_{d(on)}$	$R_{Gon} = 6,8 \Omega$	$V_{CC} = 600V$ $I_{Cnom} = 100A$	85		ns
t_r			50		ns
E_{on}	$R_{Goff} = 6,8 \Omega$	$T_j = 125^{\circ}C$	11		mJ
$t_{d(off)}$			430		ns
t_f			55		ns
E_{off}			8		mJ
$R_{th(j-c)}$	per IGBT		0,15		K/W

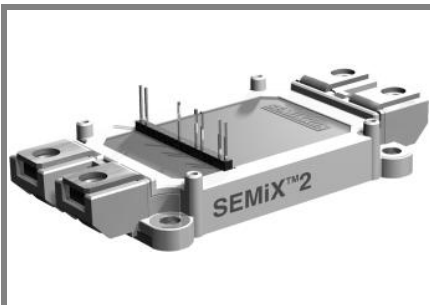

SEMiX[®] 2

SPT IGBT Modules

SEMiX 202GB128D

Preliminary Data

Features

- Homogeneous Si
- SPT = Soft-Punch-Through technology
- $V_{CE(sat)}$ with positive temperature coefficient
- High short circuit capability

Typical Applications

- AC inverter drives
- UPS
- Electronic welders up to 20 kHz

Remarks

- Not for new design



GB

Characteristics		min.	typ.	max.	Units
Inverse Diode					
$V_F = V_{EC}$	$I_{Fnom} = 100\text{ A}; V_{GE} = 0\text{ V}$		2	2,5	V
	$T_j = 25\text{ }^\circ\text{C}_{chiplev.}$				
	$T_j = 125\text{ }^\circ\text{C}_{chiplev.}$		1,8	2,3	V
V_{F0}			1,1	1,45	V
	$T_j = 25\text{ }^\circ\text{C}$				
	$T_j = 125\text{ }^\circ\text{C}$		0,85	1,2	V
r_F			9	10,5	mΩ
	$T_j = 25\text{ }^\circ\text{C}$				
	$T_j = 125\text{ }^\circ\text{C}$		9,5	11	mΩ
I_{RRM}	$I_{Fnom} = 100\text{ A}$		130		A
Q_{rr}	$di/dt = 3550\text{ A}/\mu\text{s}$		16		μC
E_{rr}	$V_{GE} = -15\text{ V}; V_{CC} = 600\text{ V}$		6		mJ
$R_{th(j-c)D}$	per diode			0,24	K/W
Module					
L_{CE}			18		nH
$R_{CC'+EE'}$	res., terminal-chip	$T_{case} = 25\text{ }^\circ\text{C}$	0,7		mΩ
		$T_{case} = 125\text{ }^\circ\text{C}$	1		mΩ
$R_{th(c-s)}$	per module		0,045		K/W
M_s	to heat sink (M5)		3	5	Nm
M_t	to terminals (M6)		2,5	5	Nm
w				250	g
Temperature sensor					
R_{100}	$T_c = 100\text{ }^\circ\text{C}$ ($R_{25} = 5\text{ k}\Omega$)		0,493±5%		kΩ
$B_{100/125}$	$R(T) = R_{100} \exp[B_{100/125} (1/T - 1/T_{100})]$; $T[\text{K}]; B$		3550±2%		K

This is an electrostatic discharge sensitive device (ESDS), international standard IEC 60747-1, Chapter IX.

This technical information specifies semiconductor devices but promises no characteristics. No warranty or guarantee expressed or implied is made regarding delivery, performance or suitability.

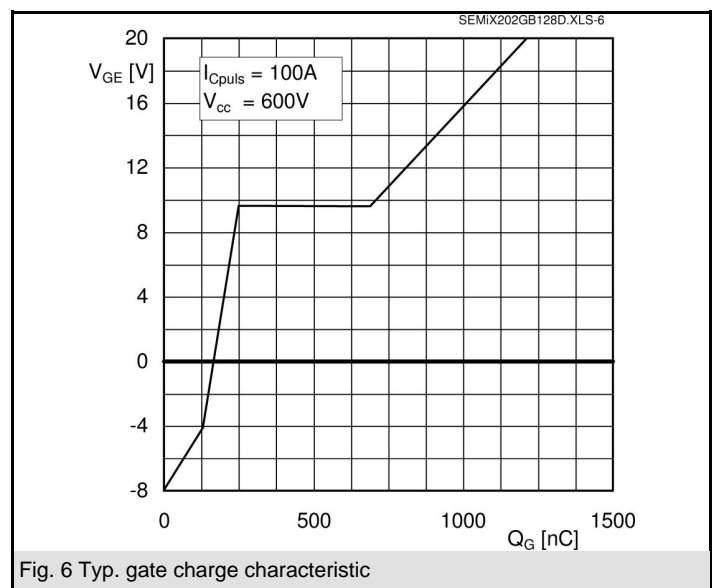
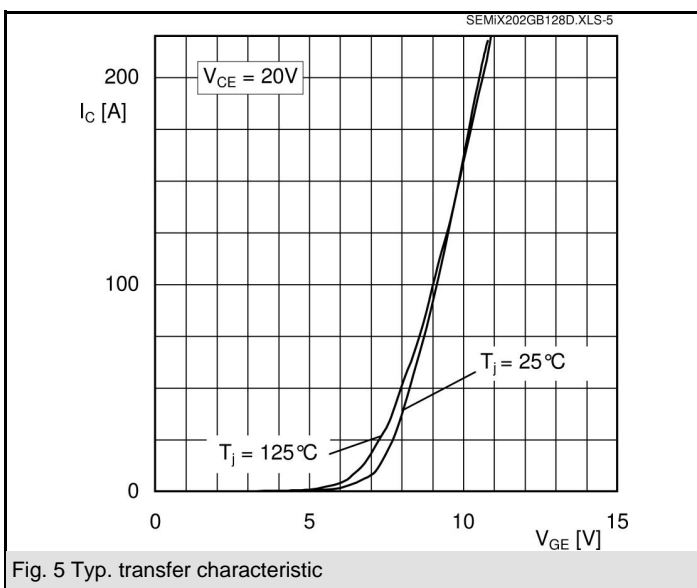
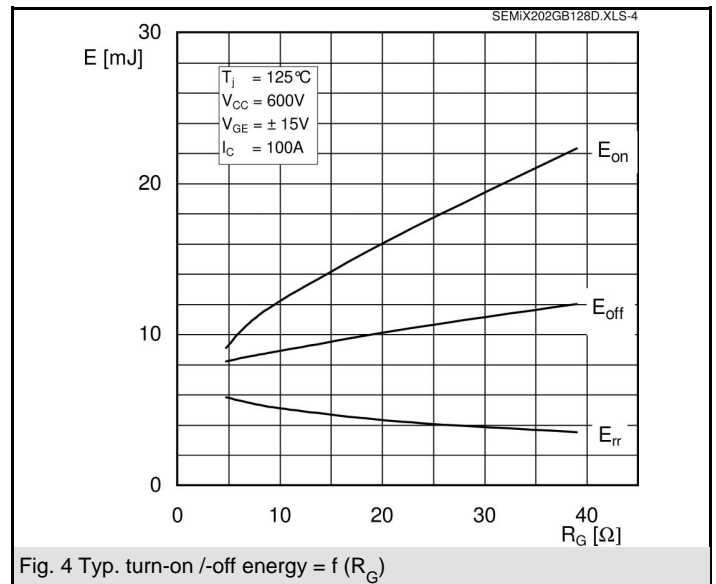
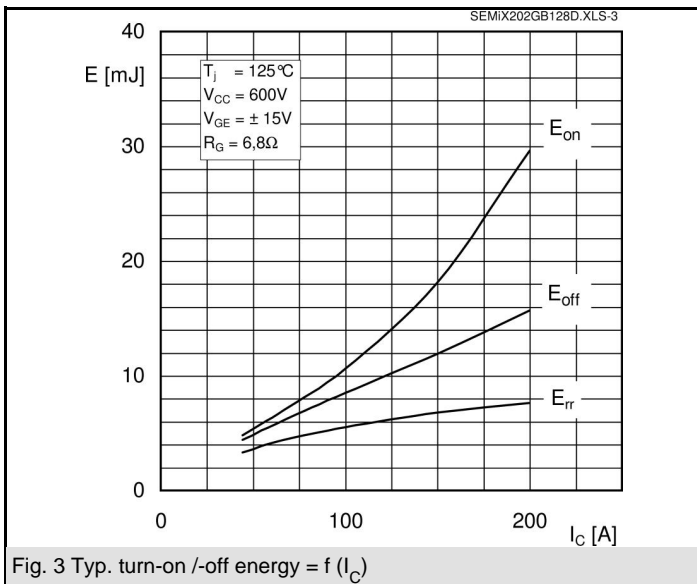
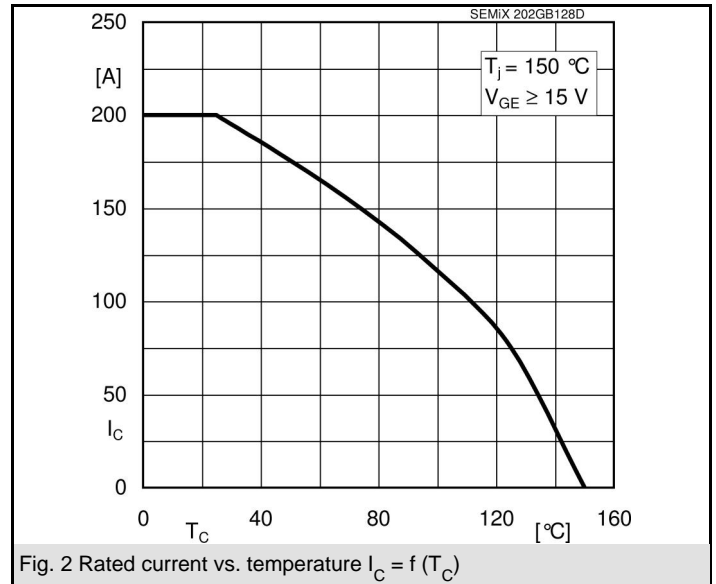
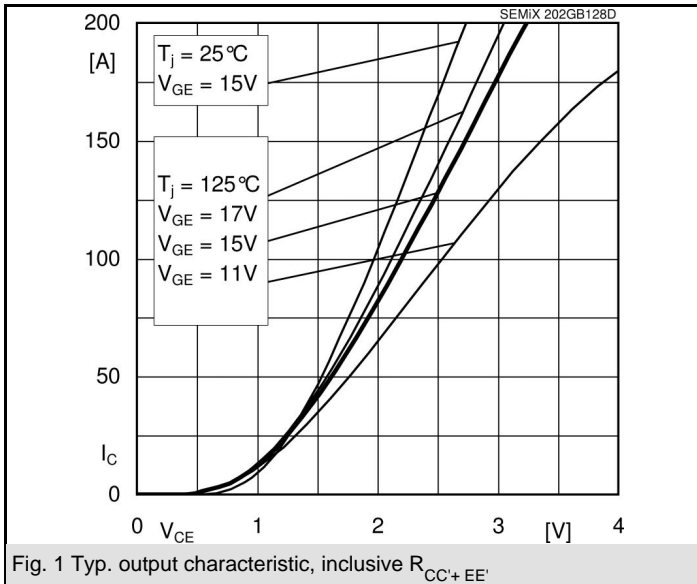

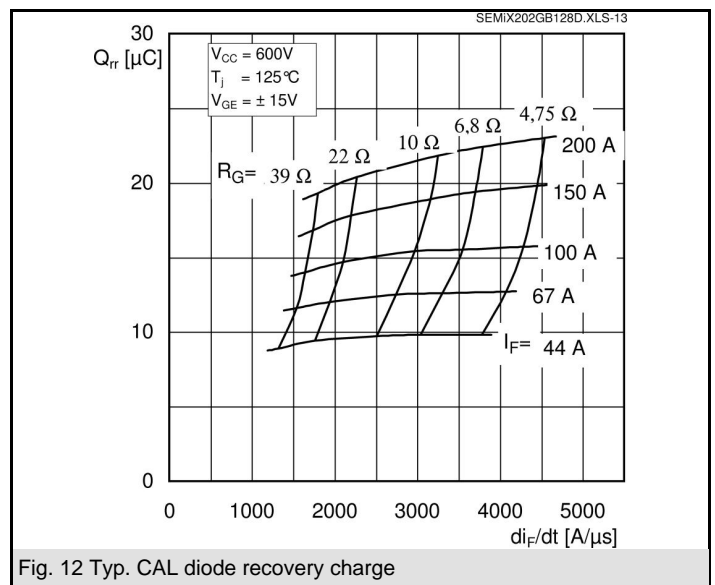
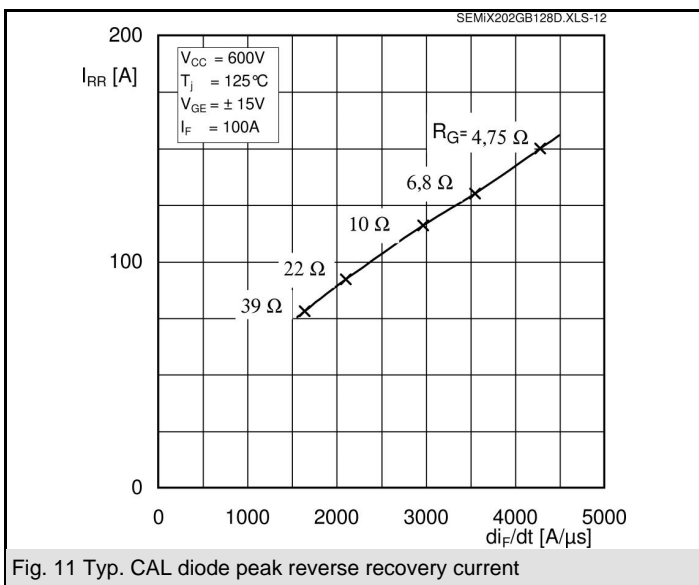
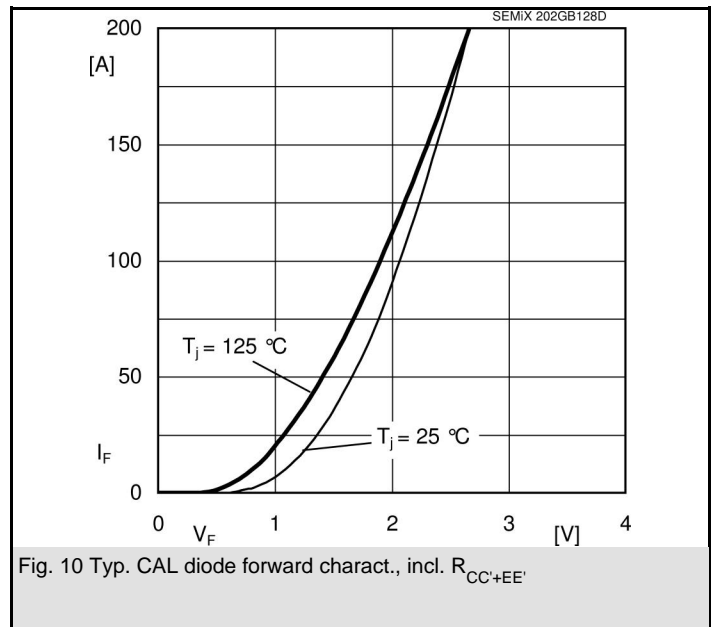
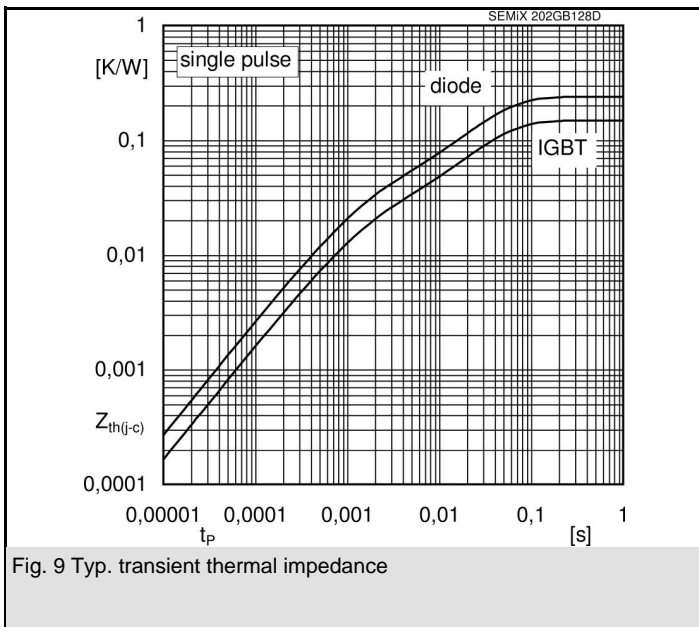
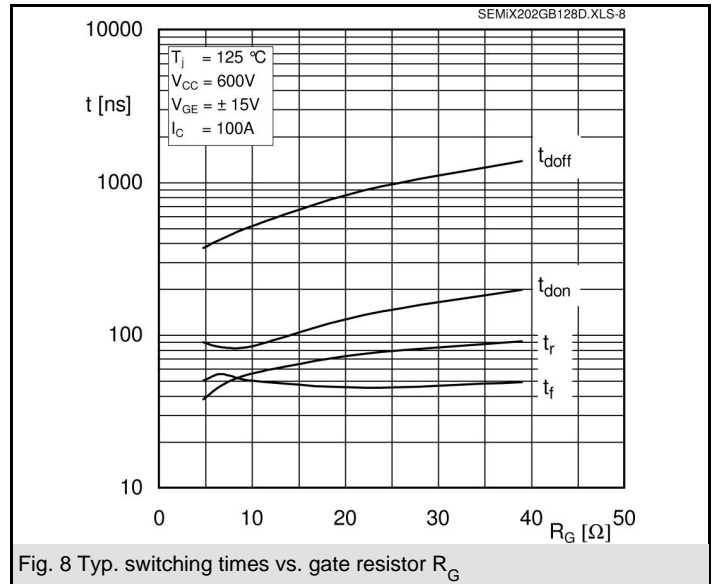
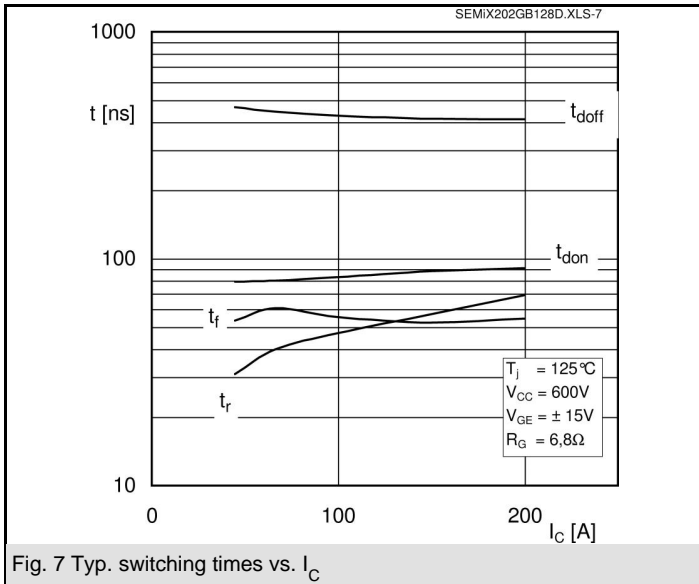

case: SEMiX 2

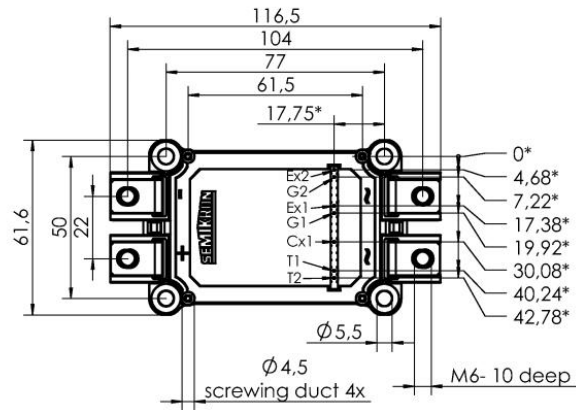
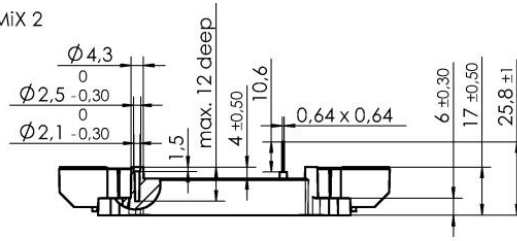

*= all measures with $\phi 0,5$

Case SEMiX 2s

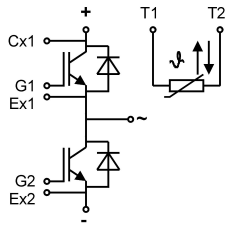

Pinout

GD