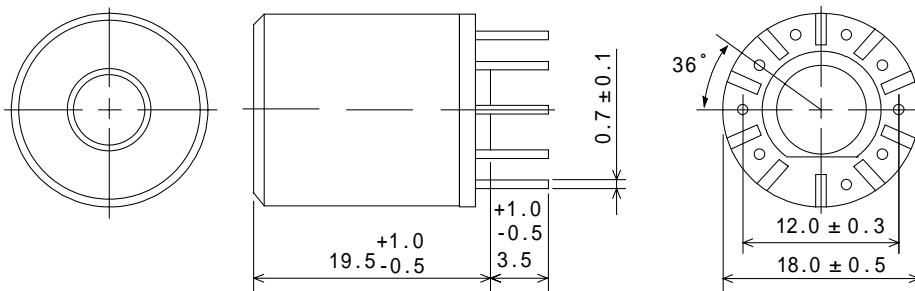
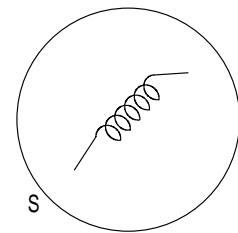

**Type: MC-182**
**Product Description**

- 18.5mm Max., 20.5mm Max. Height.
- Inductance: 1.0mH Max.
- Operating frequency: 250kHz Max.
- In addition to the reference versions of parameters shown here, custom designs are available to meet your exact requirements.

**Feature**

- High inductance fixed shielded type.
- Can be used as DC-DC converter transformer.
- RoHS Compliance

**Dimensions (mm)**

**Connection (Bottom View)**

"S" is winding start.

- \* Dimension does not include solder used on coil.
- \* Pin pitch should be measured at the root of terminal.

**Specification**

| NO. | Part No.     | Stamp | Inductance (at 1 kHz)<br><Within> 1 | D.C.R. (Ω)<br><MAX.> | Rated Current<br>(A) 1 |
|-----|--------------|-------|-------------------------------------|----------------------|------------------------|
| 01  | MC182NP-5ØØM | 500M  | 50 μH ± 20%                         | 0.04                 | 3.5                    |
| 02  | MC182NP-1Ø1M | 101M  | 100 μH ± 20%                        | 0.10                 | 2.5                    |
| 03  | MC182NP-2Ø1M | 201M  | 200 μH ± 20%                        | 0.15                 | 2.1                    |
| 04  | MC182NP-3Ø1M | 301M  | 300 μH ± 20%                        | 0.22                 | 1.6                    |
| 05  | MC182NP-4Ø1M | 401M  | 400 μH ± 20%                        | 0.26                 | 1.5                    |
| 06  | MC182NP-6Ø1M | 601M  | 600 μH ± 20%                        | 0.48                 | 1.1                    |
| 07  | MC182NP-8Ø1M | 801M  | 800 μH ± 20%                        | 0.58                 | 1.0                    |
| 08  | MC182NP-1Ø2M | 102M  | 1.0mH ± 20%                         | 0.66                 | 0.9                    |

1 Rated current: The D.C. current at which the inductance decreases to 90% of its initial value or when  $t=40$ , whichever is lower ( $T_a=20$ )