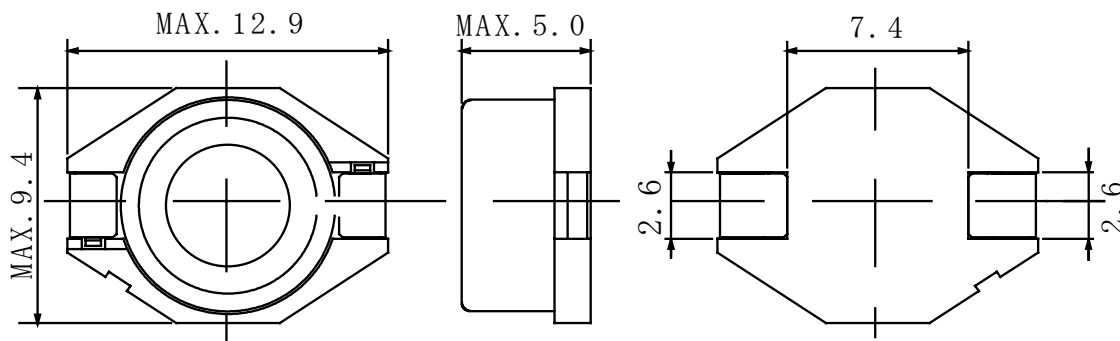
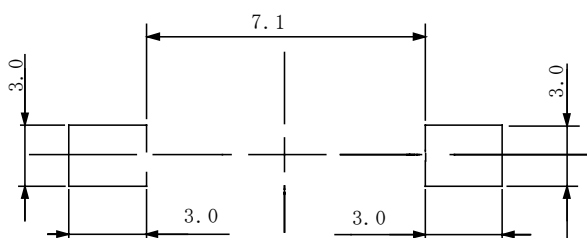

**Type:CDRR94A**
**◆ Product Description**

- 12.9×9.4mm Max. (L×W), 5.0 mm Max. Height.
- Inductance range: 1.0~330  $\mu$  H.
- Rated current range: 0.38~5.2A.
- In addition to the standards versions shown here, custom inductors are also available to meet your exact requirements.

**◆ Feature**

- Magnetically shielded construction.
- Ideally used in Portable PC, Video Recorder, DSC/DVC, HDD, etc as DC-DC Converter inductors.
- RoHS Compliance.

**◆ Dimensions (mm)**

**◆ Land Pattern (mm)**

**Type:CDRR94A**
**◆ Specification**

Part Name ※	Stamp	Inductance [Within] 100kHz	D.C.R.(mΩ) Max.(Typ.) (at 20°C)	Saturation Current (A) ※1	Temperature rise current (A)※2
CDRR94ANP-1R0P□	1R0	1.0μH ± 25%	15.2(12.2)	7.60	5.20
CDRR94ANP-1R5M□	1R5	1.5μH ± 20%	17.0(13.6)	6.24	4.80
CDRR94ANP-2R2M□	2R2	2.2μH ± 20%	19.3(15.4)	5.44	4.60
CDRR94ANP-3R3M□	3R3	3.3μH ± 20%	23.4(18.7)	4.32	3.80
CDRR94ANP-4R7M□	4R7	4.7μH ± 20%	28.4(22.7)	3.52	3.70
CDRR94ANP-6R8M□	6R8	6.8μH ± 20%	34.0(27.2)	2.98	3.30
CDRR94ANP-100M□	100	10 μH ± 20%	51.2(41.0)	2.48	2.50
CDRR94ANP-120M□	120	12 μH ± 20%	58.3(46.6)	2.24	2.25
CDRR94ANP-150M□	150	15 μH ± 20%	65.7(52.6)	1.96	2.25
CDRR94ANP-180M□	180	18 μH ± 20%	73.1(58.5)	1.88	2.12
CDRR94ANP-220M□	220	22 μH ± 20%	95.6(76.5)	1.66	1.72
CDRR94ANP-270M□	270	27 μH ± 20%	112.0(89.6)	1.56	1.60
CDRR94ANP-330M□	330	33 μH ± 20%	143.9(115.1)	1.36	1.41
CDRR94ANP-390M□	390	39 μH ± 20%	164.2(131.4)	1.26	1.34
CDRR94ANP-470M□	470	47 μH ± 20%	178.1(142.5)	1.12	1.32
CDRR94ANP-560M□	560	56 μH ± 20%	224.7(179.7)	1.00	1.13
CDRR94ANP-680L□	680	68 μH ± 15%	312.0(250.0)	0.85	0.87
CDRR94ANP-820M□	820	82 μH ± 20%	341.9(273.5)	0.85	0.83
CDRR94ANP-101M□	101	100μH ± 20%	406.7(325.4)	0.80	0.76
CDRR94ANP-121M□	121	120μH ± 20%	526.8(421.4)	0.71	0.64
CDRR94ANP-151M□	151	150μH ± 20%	708.3(566.6)	0.65	0.55
CDRR94ANP-181M□	181	180μH ± 20%	784.8(627.8)	0.60	0.54
CDRR94ANP-221M□	221	220μH ± 20%	1043.3(834.6)	0.54	0.45
CDRR94ANP-271M□	271	270μH ± 20%	1174.8(939.8)	0.49	0.43
CDRR94ANP-331M□	331	330μH ± 20%	1353.5(1082.8)	0.44	0.38

**※ Description of Part Name**

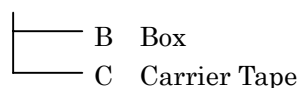
CDRR94NP-1R0M□



※1. Saturation current: The DC current at which the inductance decreases to 90% of it's initial value.

 ※2. Temperature rise current: The DC current at which the temperature rise is  $\Delta t=40^{\circ}\text{C}$ . ( $T_a=20^{\circ}\text{C}$ ).