

**Type: CAS143**

**Product Description**

- 11.55 x 3.3mm Max.(L x W),3.55mm Max. Height.
- Operating temperature: - 40 ~ + 125 .
- Encapsulated core and winding for high mechanical performance.

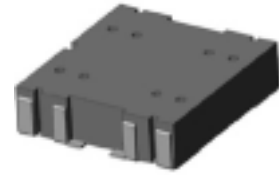

**Feature**

- LF transponder 3 axle's type receiver antenna.
- Ideally used in keyless smart entry system.
- RoHS Compliance.

**Dimensions (mm)**

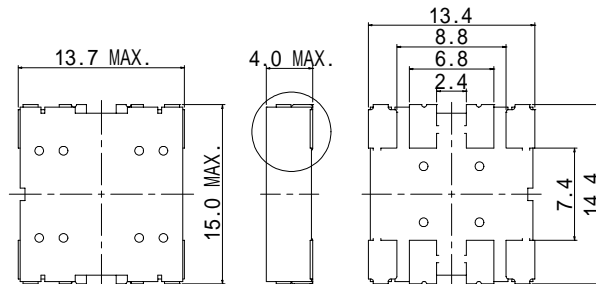

**Land Pattern (mm)**

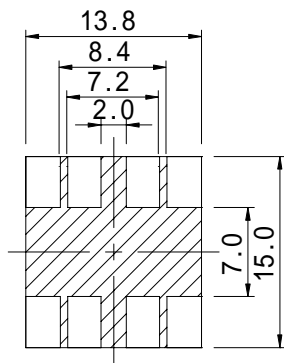

**Schematics(Bottom)**

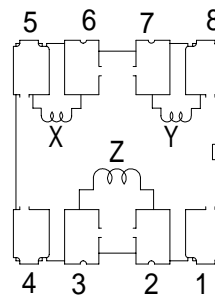

**Specification**

	Between (5-6) (X axle)	Between (7-8) (Y axle)	Between (2-3) (Z axle)	Testing Conditions
Inductance	4.7mH ± 5% Within	4.7mH ± 5% Within	4.7mH ± 5% Within	125kHz、 1V
Unloaded Q	47 (Ref.)	45 (Ref.)	50 (Ref.)	125kHz、 1V
S.R.F.	800kHz(Ref.)	800kHz(Ref.)	500kHz(Ref.)	