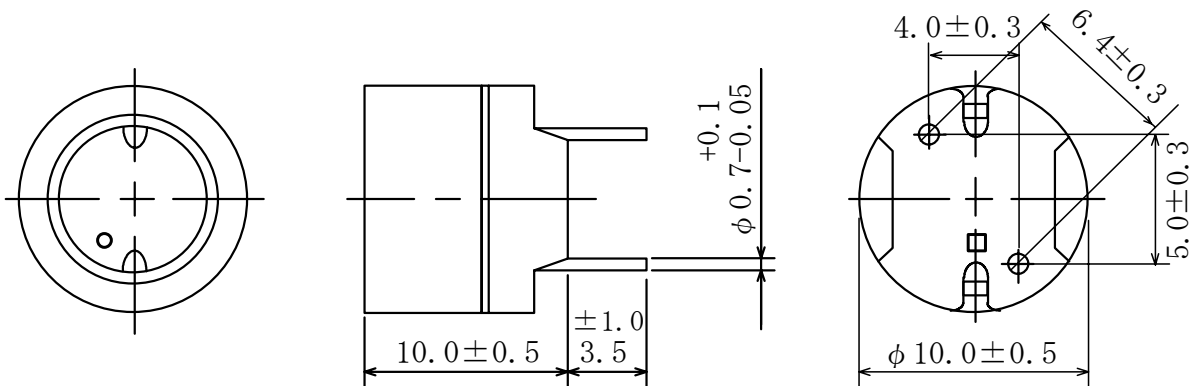

Type: RCR1010
◆ Product Description

- 10.5mm Max. ϕ , 10.5mm Max. Height.
- Inductance Range: 10 μ H ~ 1.0mH
- Rated Current Range: 0.48 ~ 4.8A
- In addition to the standard versions of inductors shown here, custom inductors are available to meet your exact requirements

◆ Feature

- Magnetically shielded construction.
- Ideally Used in Printers, LCD TV, DVD, Printer, Copy Machine, Mainboard of the compounding machines, etc as Power Supplies's Inductors or DC-DC Converter inductors.
- RoHS Compliance

◆ Dimensions (mm)

Type: RCR1010
◆ Specification

Part Name	Stamp	Inductance [Within] 100kHz/1V	D.C.R.(mΩ) Max.(Typ.) (at 20°C)	Mounting Holes (mm) ※3	Saturation Current (A) ※1		Temperature Rise current (A) ※2
					(at 20°C)	(at 105°C)	
RCR1010NP-100M	100M	10 μ H±20%	25.1(20.1)	1.4	4.8	3.8	4.3
RCR1010NP-120M	120M	12 μ H±20%	26.6(21.3)	1.4	4.5	3.5	4.2
RCR1010NP-150M	150M	15 μ H±20%	31.3(25.1)	1.4	4.0	3.2	4.1
RCR1010NP-180M	180M	18 μ H±20%	33.8(27.1)	1.4	3.8	2.9	4.0
RCR1010NP-220M	220M	22 μ H±20%	38.3(30.6)	1.4	3.4	2.6	3.8
RCR1010NP-270M	270M	27 μ H±20%	40.9(32.7)	1.4	3.0	2.5	3.6
RCR1010NP-330M	330M	33 μ H±20%	53.8(43.1)	1.2	2.7	2.2	3.2
RCR1010NP-390M	390M	39 μ H±20%	73.4(58.7)	1.2	2.5	2.0	2.5
RCR1010NP-470M	470M	47 μ H±20%	102.1(81.7)	1.2	2.2	1.8	2.2
RCR1010NP-560M	560M	56 μ H±20%	111.3(89.0)	1.2	2.1	1.7	2.1
RCR1010NP-680M	680M	68 μ H±20%	137.5(110.0)	1.0	1.8	1.4	1.9
RCR1010NP-820M	820M	82 μ H±20%	160.0(128.0)	1.0	1.7	1.3	1.8
RCR1010NP-101M	101M	100 μ H±20%	175.3(140.2)	1.0	1.5	1.2	1.7
RCR1010NP-121M	121M	120 μ H±20%	193.8(155.0)	1.0	1.4	1.1	1.6
RCR1010NP-151M	151M	150 μ H±20%	225.6(180.5)	1.0	1.2	1.0	1.5
RCR1010NP-181M	181M	180 μ H±20%	275.3(220.2)	1.0	1.1	0.9	1.4
RCR1010NP-221M	221M	220 μ H±20%	313.0(250.5)	1.0	1.0	0.8	1.3
RCR1010NP-271M	271M	270 μ H±20%	450.6(360.5)	1.0	0.95	0.74	1.0
RCR1010NP-331M	331M	330 μ H±20%	500.6(400.5)	1.0	0.88	0.64	0.98
RCR1010NP-391M	391M	390 μ H±20%	563.0(450.5)	1.0	0.78	0.60	0.94
RCR1010NP-471M	471M	470 μ H±20%	748.8(599.0)	1.0	0.72	0.58	0.80
RCR1010NP-561M	561M	560 μ H±20%	848.8(682.9)	1.0	0.68	0.55	0.75
RCR1010NP-681M	681M	680 μ H±20%	1202(962.0)	1.0	0.60	0.48	0.63
RCR1010NP-821M	821M	820 μ H±20%	1342(1074)	1.0	0.57	0.45	0.60
RCR1010NP-102M	102M	1.0mH±20%	1490(1192)	1.0	0.48	0.39	0.55

※1. Saturation current: The DC current at which the inductance decreases to 80% of it's initial value.

※2: Temperature rise current: The DC current at which the temperature rise is Δt=40°C.(Ta=20°C).

※3. Please give sufficient consideration to the thickness of wire while mounted into the P.C.B.

(mounting holes mm)