

With Button Tactile Switches SOE Series

FEATURES

1. Minimized surface area.
2. Excellent sealing to resist contamination and flux.
3. Stainless steel click springs provide a sharp tactile sensation and long life.
4. Ideal for setting narrow key pitch.
5. SMT type and reflow-soldering for surface mounting.

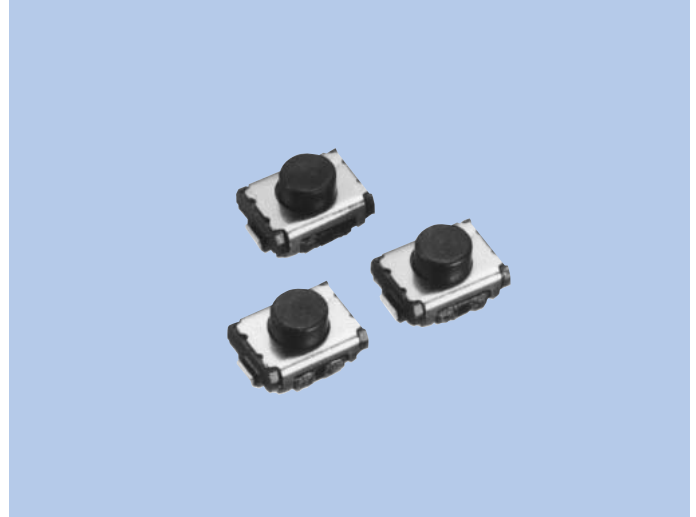

USES

1. To accommodate the narrow key pitch in new markets such as car audio.

MODEL NAME CODE

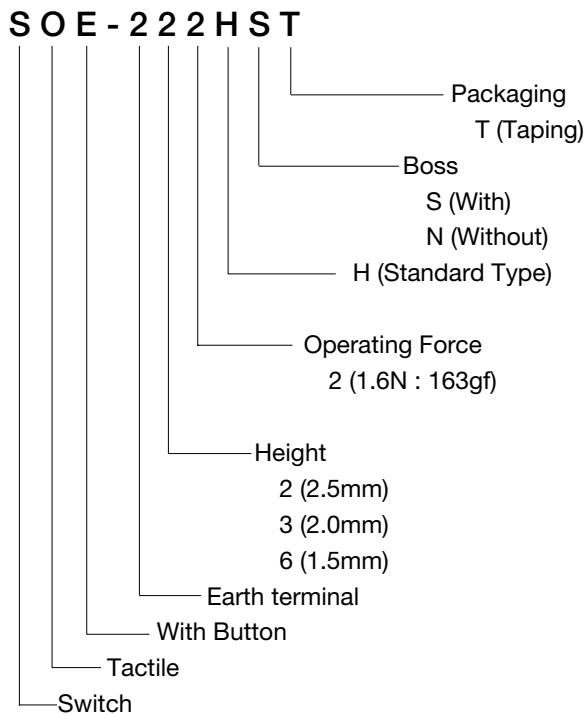

SPECIFICATIONS

Electrical Characteristics	Rating	50mA, 12V DC
	Contact Resistance	100mΩ or less
	Insulation Resistance	100MΩ or more
	Withstand Voltage	1 minute at 250V
Mechanical Characteristics	Operating Force	1.6N (163gf)
	Life	100,000cycles

TYPE

Model Name Code	Order Number	Operating Force	Boss	Mounting Height	Pcs
SOE-222HST	R66 6112	1.6N(163gf)	With	2.5mm	4,000
SOE-222HNT	R66 6113	1.6N(163gf)	Without	2.5mm	4,000
SOE-232HST	R66 6114	1.6N(163gf)	With	2.0mm	4,000
SOE-232HNT	R66 6115	1.6N(163gf)	Without	2.0mm	4,000
SOE-262HST	R66 6159	1.6N(163gf)	With	1.5mm	4,000
SOE-262HNT	R66 6160	1.6N(163gf)	Without	1.5mm	4,000

DIMENSIONS

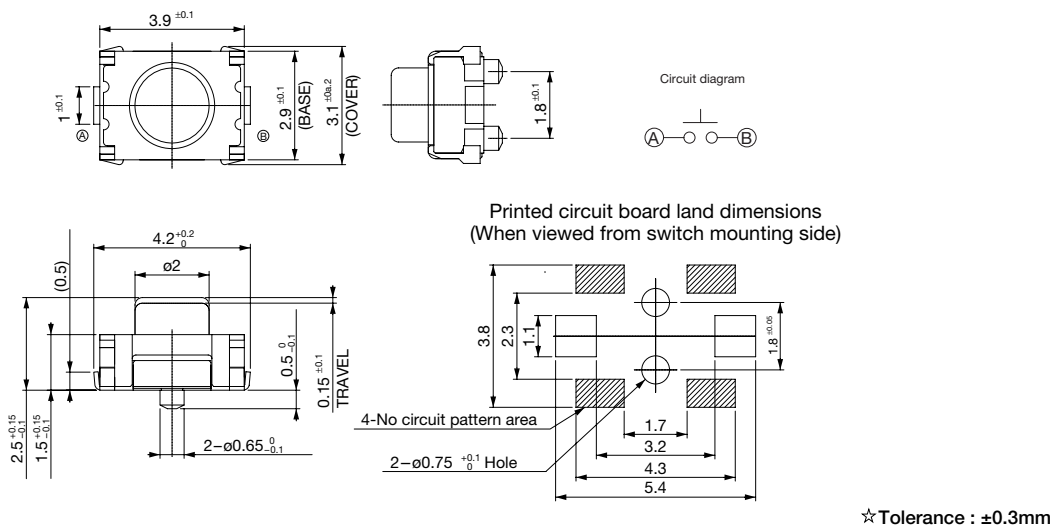

Reel Dimensions

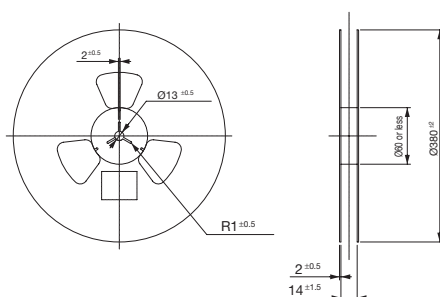

Plastic Tape Dimensions

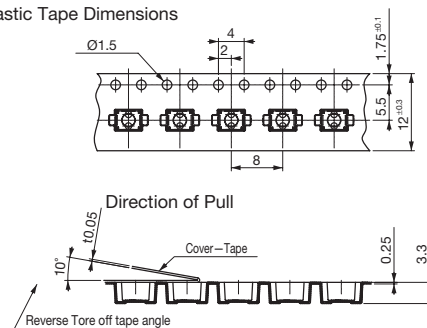

Fig-3 TOLERANCE ±0.1

*One reel accommodates 4,000 pieces (∅380).

Unit : mm