

# SMT Power Inductor

## SIL740 Type

### Features

- Small size (6.6mm\*6.6mm), low profile (4.0mm max. height) SMD type.
- Magnetically shielded, suitable for high density mounting.
- High energy storage and low DCR.
- Provided with embossed carrier tape packing.
- Ideal for power source circuits, DC-DC converter, DC-AC inverters inductor application.
- In addition to the standard versions shown here, custom inductors are available to meet your exact requirements.

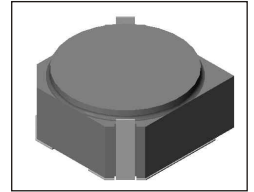

### Mechanical Dimension: Unit: mm

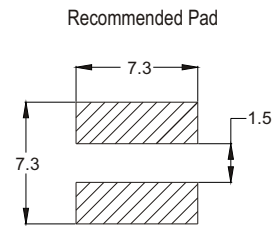
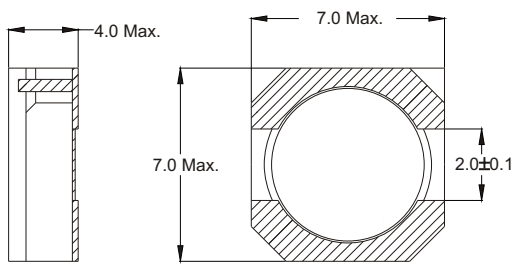

### Electrical Characteristics:

PART NO.	L* (uH)	DCR (Ω) MAX	I <sub>RATED</sub> ** (A dc)
SIL740 - 3R3	3.3	0.020	3.50
SIL740 - 5R0	5.0	0.024	2.90
SIL740 - 6R2	6.2	0.027	2.50
SIL740 - 7R4	7.4	0.031	2.30
SIL740 - 8R6	8.6	0.034	2.20
SIL740 - 100	10	0.038	2.00
SIL740 - 120	12	0.053	1.70
SIL740 - 150	15	0.057	1.60
SIL740 - 180	18	0.092	1.50
SIL740 - 220	22	0.096	1.30
SIL740 - 270	27	0.109	1.20
SIL740 - 330	33	0.124	1.10
SIL740 - 390	39	0.138	1.00
SIL740 - 470	47	0.155	0.95
SIL740 - 560	56	0.202	0.85
SIL740 - 680	68	0.234	0.75
SIL740 - 820	82	0.324	0.70
SIL740 - 101	100	0.358	0.65

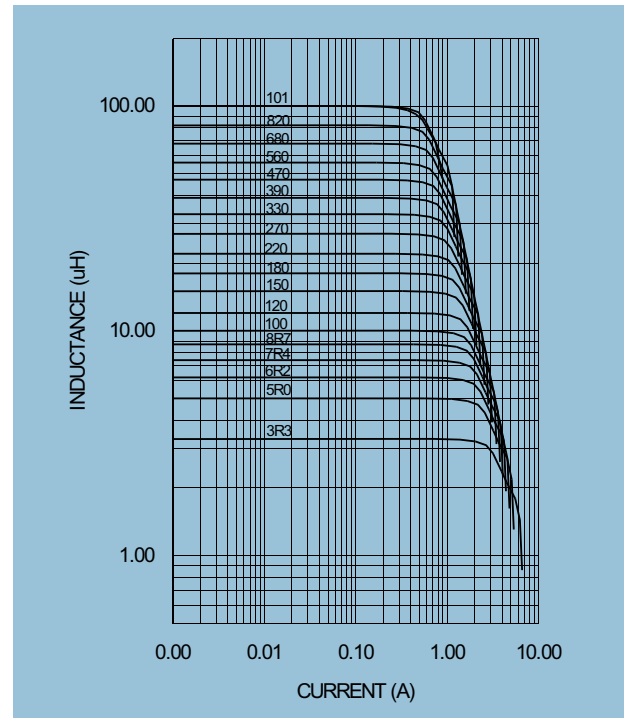

★ Tolerance of inductance  
3.3~100uH±30%

★★ I<sub>RATED</sub>: rated current. ΔL<35%, ΔT<45°C at I<sub>RATED</sub>

★★★ Operating temperature: -20°C to 105°C (including self-temperature rise)

★★★★ Test condition at 25°C: 100KHz, 0.1V



**DELTA ELECTRONICS, INC.**

(TAOYUAN PLANT CPBG) 252, SAN YING ROAD, KUEISAN INDUSTRIAL ZONE, TAOYUAN SHIEN, 333, TAIWAN, R.O.C.

TEL: 886-3-3591968; FAX: 886-3-3591991

<http://www.deltawww.com>