



**Solid State Devices, Inc.**

14701 Firestone Blvd \* La Mirada, Ca 90638  
 Phone: (562) 404-4474 \* Fax: (562) 404-1773  
 ssdi@ssdi-power.com \* www.ssdi-power.com

**SDAD101 Series**

**2,500 to 15,000 VOLTS  
 STANDARD RECOVERY  
 STACKABLE HIGH VOLTAGE RECTIFIER**

**Designer's Data Sheet**

**Part Number/Ordering Information <sup>1/</sup>**  
 SDAD10 1

**+ Screening <sup>2/</sup>**  
 \_\_\_ = Not Screened  
 TX = TX Level  
 TXV = TXV  
 S = S Level

**+ Reverse Recovery Time**  
 \_\_\_ = Standard Recovery Time

**+ Voltage** 2.5 = 2.5kV, 5 = 5kV,  
 7.5 = 7.5kV, 10 = 10kV, and 15 = 15kV

**+ Power Rating** (See Below)

**+ Package Size** = 1 Inch Diameter

- FEATURES:**
- Stackable to 160kV
  - PIV 2.5kV to 15kV
  - Standard Reverse Recovery Time
  - Only Hermetically Sealed Rectifiers Used
  - Controlled Avalanche Rated
  - Modular Design for Easy Stacking
  - Storage and Operating Temps -65 C to +150 C
  - Available in Fast, Ultra Fast and Hyper Fast Versions
  - TX, TXV, and S-Level Screening Available <sup>2/</sup>
  - Replacement Upgrade - Unitorde Types USB2.5 Through USS15

**ELECTRICAL CHARACTERISTICS <sup>3/</sup>**

Part Number	Peak Inverse Voltage	Reverse Recovery Time <sup>5/</sup>	Average DC Output Current <sup>4/</sup>		Surge Non-repetitive	Maximum Forward Voltage Drop		Maximum Leakage Current @PIV	Replacement Part Number
	PIV (KV)	Max (ns)	If(avg)		Ifsm	Vf (V)	If (A)	Ir (uA)	
			75 °C	50 °C		25 °C	25 °C		
SDAD101 B 2.5	2.5	5000	1.10	2.30	80	5.0	1.1	10	USB-2.5
SDAD101 B 5.0	5.0	5000	0.68	1.50	80	9.0	0.7	10	USB-5
SDAD101 S 5.0	5.0	5000	0.60	1.10	25	9.0	0.6	5	USS-5
SDAD101 B 7.5	7.5	5000	0.53	1.20	80	13.0	0.5	10	USB-7.5
SDAD101 S 7.5	7.5	5000	0.45	0.91	25	13.0	0.5	5	USS-7.5
SDAD101 B 10	10	5000	0.43	1.00	80	17.0	0.4	10	USB-10
SDAD101 S 10	10	5000	0.35	0.71	25	17.0	0.3	5	USS-10
SDAD101 S 15	15	5000	0.25	0.51	25	25	0.2	5	USS-15
High Current Versions									
SDAD101 H 2.5	2.5	5000	2.20	4.60	150	3.3	2.2	10	---
SDAD101 H 5.0	5.0	5000	1.36	3.00	150	5.5	1.3	10	---
SDAD101 H 7.5	7.5	5000	1.06	2.40	150	8.2	1.0	10	---
SDAD101 H 10	10	5000	0.86	2.00	150	10.7	0.8	10	---
SDAD101 H 15	15	5000	0.50	1.00	30	15.7	0.5	10	---

**SDAD101 Package:**

**NOTES:**

- 1/ For Ordering Information, Price, Curves, and Availability- Contact Factory.
- 2/ Screened to MIL-PRF-19500.
- 3/ Unless Otherwise Specified, All Electrical Characteristics @25°C.
- 4/ Tc = 50 °C typical operation in oil.  
 Tc = 75 °C is typical ambient Ta = 25 °C unheatsunk.
- 5/ Recovery Conditions: If = 0.5 Amp, Ir = 1.0 Amp rec. to .25 Amp.

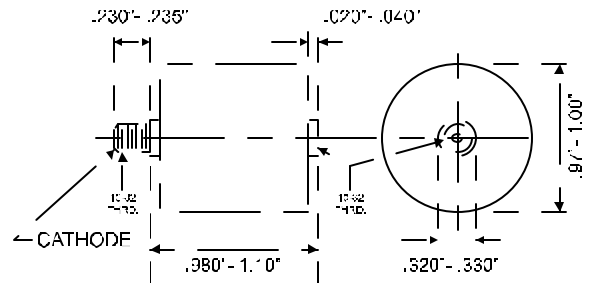

**NOTE:** All specifications are subject to change without notification. SCD's for these devices should be reviewed by SSDI prior to release.

**DATA SHEET #: RA0068B**

**DOC**