

Surface Mount Aluminum Electrolytic Capacitors NACNW Series

FEATURES

- CYLINDRICAL V-CHIP CONSTRUCTION FOR SURFACE MOUNTING
- NON-POLARIZED, 1000 HOURS AT 105°C
- 5.5mm HEIGHT
- ANTI-SOLVENT (2 MINUTES)
- DESIGNED FOR REFLOW SOLDERING

**RoHS
Compliant**

includes all homogeneous materials

*See Part Number System for Details

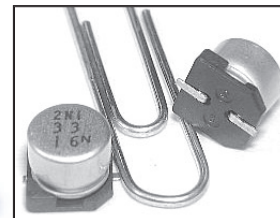

CHARACTERISTICS

| | | | | | | | |
|---|--------------------|--|------|------|------|------|------|
| Rated Voltage Range | 6.3 ~ 50Vdc | | | | | | |
| Rated Capacitance Range | 0.1 ~ 47μF | | | | | | |
| Operating Temp. Range | -55 ~ +105°C | | | | | | |
| Capacitance Tolerance | ±20% (M) | | | | | | |
| Max. Leakage Current After 1 Minutes @ 20°C | 0.03CV + 8μA max. | | | | | | |
| Tan δ @ 120Hz/20°C | W.V. (Vdc) | 6.3 | 10 | 16 | 25 | 35 | 50 |
| | Tan δ @ 120Hz/20°C | 0.24 | 0.22 | 0.20 | 0.20 | 0.20 | 0.18 |
| Low Temperature Stability Impedance Ratio @ 120Hz | W.V. (Vdc) | 6.3 | 10 | 16 | 25 | 35 | 50 |
| | Z -25°C/Z +20°C | 3 | 3 | 2 | 2 | 2 | 2 |
| | Z -40°C/Z +20°C | 8 | 8 | 4 | 4 | 3 | 3 |
| Load Life Test 105°C 1,000 Hours (Reverse polarity every 500 Hours) | Capacitance Change | Within ±25% of initial measured value | | | | | |
| | Tan δ | Less than 200% of specified max. value | | | | | |
| | Leakage Current | Less than specified max. value | | | | | |

STANDARD VALUES, CASE SIZES & SPECIFICATIONS

| Cap. (μF) | Working Voltage | Case Size | Max. ESR (Ω) AT 120Hz/20°C | Max. Ripple Current (mA rms) AT 120Hz/105°C |
|-----------|-----------------|-----------|----------------------------|---|
| 22 | 6.3Vdc | 5X5.5 | 18.09 | 22 |
| 33 | | 6.3X5.5 | 12.06 | 27 |
| 47 | | 6.3X5.5 | 8.47 | 33 |
| 10 | 10Vdc | 4X5.5 | 36.49 | 12 |
| 22 | | 6.3X5.5 | 16.59 | 25 |
| 33 | | 6.3X5.5 | 11.06 | 30 |
| 4.7 | 16Vdc | 4X5.5 | 70.58 | 8 |
| 10 | | 5X5.5 | 33.17 | 17 |
| 22 | | 6.3X5.5 | 15.08 | 27 |
| 33 | | 6.3X5.5 | 10.05 | 40 |
| 3.3 | 25Vdc | 4X5.5 | 100.53 | 7 |
| 4.7 | | 5X5.5 | 70.58 | 13 |
| 10 | 6.3X5.5 | 33.17 | 20 | |
| 2.2 | 35Vdc | 4X5.5 | 150.79 | 5.9 |
| 3.3 | | 5X5.5 | 100.53 | 12 |
| 4.7 | | 5X5.5 | 70.58 | 14 |
| 10 | 6.3X5.5 | 33.17 | 21 | |
| 0.1 | 50Vdc | 4X5.5 | 2985.67 | 0.7 |
| 0.22 | | 4X5.5 | 1357.12 | 1.6 |
| 0.33 | | 4X5.5 | 904.75 | 2.4 |
| 0.47 | | 4X5.5 | 635.25 | 3.5 |
| 1.0 | | 4X5.5 | 298.57 | 7 |
| 2.2 | | 5X5.5 | 135.71 | 10 |
| 3.3 | | 5X5.5 | 90.47 | 13 |
| 4.7 | | 6.3X5.5 | 63.52 | 16 |

PART NUMBER SYSTEM

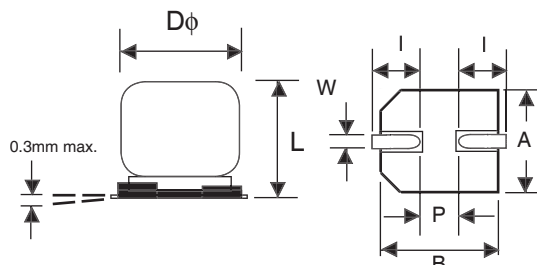
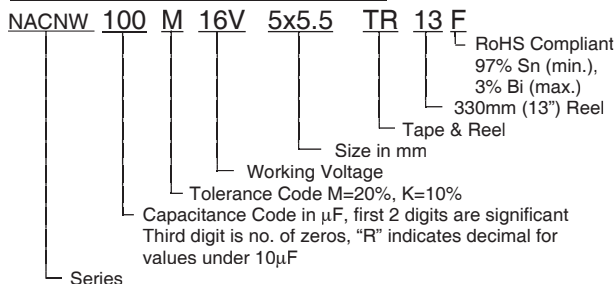

DIMENSIONS (mm)

| Case Size | Dφ ± 0.5 | L max. | A ± 0.2 | l ± 0.2 | W | P ± 0.2 |
|-----------|----------|--------|---------|---------|-----------|---------|
| 4x5.5 | 4.0 | 5.5 | 4.3 | 1.8 | 0.5 ~ 0.8 | 1.0 |
| 5x5.5 | 5.0 | 5.5 | 5.3 | 2.1 | 0.5 ~ 0.8 | 1.4 |
| 6.3x5.5 | 6.3 | 5.5 | 6.6 | 2.5 | 0.5 ~ 0.8 | 2.2 |

PRECAUTIONS

Please review the notes on correct use, safety and precautions found on pages T10 & T11 of NIC's Electrolytic Capacitor catalog.
Also found at www.niccomp.com/precautions
If in doubt or uncertainty, please review your specific application - process details with NIC's technical support personnel: tpmg@niccomp.com

