

No. 424 / X-SMQ

This product is not recommended for new designs. Please refer to Littelfuse No. 154.

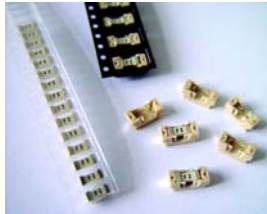

Dimensions (mm)

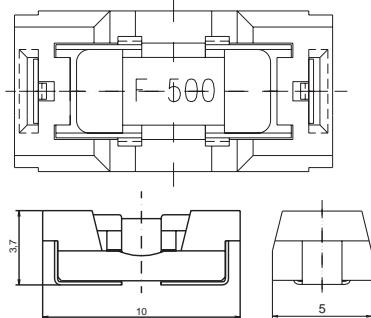

Pad Layout

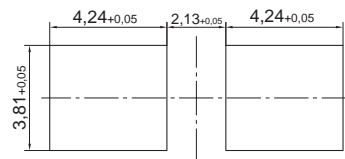

Limits for Pre-arcing Time

Rated Current	$2.0 \times I_N$
62mA ... 7.00A	< 5s

UL 248-14, 125V, F

Holder with mounted fuse No. 419

Time-Current Characteristic
Quick acting (F)

Standard
UL 248-14
CSA C22.2 No. 248.14

Approvals
cULus Recognized

Features

- Easy exchange of the fuse
- For line or low voltage applications
- Low voltage drop
- Internationally approved
- High pulse resistance
- For reflow soldering

WebLinks

Further info see:
www.wickmanngroup.com

Further application info see Fuseology:
www.wickmann.com/download/fuseology.pdf

Specifications

Packaging

010: Blister tape 38 cm reel (1500 pcs.)
tape width 16 mm

Materials of the Holder

Housing: Holder plastics UL94 V-0
Terminals: Copper alloy, Ni+Sn plated, lead free

Operating Temperature

-55°C to +125°C (consider de-rating)

Climatic Category

-55°C/+125°C/21 days (IEC 60068-2-1...3)

Stock Conditions

+10°C to +60°C
relative humidity ≤ 75% yearly average,
without dew, maximum value for 30 days-95%

Vibration Resistance

24 cycles at 15 min. each (IEC 60068-2-6)
10 - 60Hz at 0.75mm amplitude
60 - 2000Hz at 10g acceleration

Solderability

235°C, 3 sec. (IEC 60068-2-58)

Soldering Heat Resistance

260°C, 10 sec. (IEC 60068-2-58)
280°C, 5 sec.

Minimum Cross Section, Copper

Conducting path - 0.1mm²
Thickness - 0.035mm

Mounting

Avoid circuit traces below the fuse

Marking on fuse

F, Current Rating

Unit Weight

0.4g (approx.)



Permissible continuous operating current is ≤ 70% at ambient temperature of 23°C (73.4°F).

Rated Current	Amp code	Voltage Rating	Breaking Capacity	Voltage Drop 1.0 x I _N typ. (mV)	Power Dissipation 1.0 x I _N typ. (mW)	Melting Integral 10 x I _N min. (A ² s)	Approbationen cULus
62mA	0062	125V		1600	85	0.00014 0.000095	•
125mA	0125	125V		1300	120	0.00085 0.00067	•
250mA	0250	125V		950	150	0.0065 0.0052	•
500mA	0500	125V		360	200	0.093 0.074	•
750mA	0750	125V		350	300	0.25 0.20	•
1.00A	1100	125V	50A/125VAC/DC 50-60Hz cosφ=1.0	210	230	0.50 0.42	•
1.50A	1150	125V		250	500	1.10 0.95	•
2.00A	1200	125V		180	400	1.10 0.90	•
2.50A	1250	125V		220	550	1.20 0.95	•
3.00A	1300	125V		160	600	2.00 1.70	•
4.00A	1400	125V		140	670	4.30 3.42	•
5.00A	1500	125V		130	750	7.50 6.80	•
7.00A	1700	125V	35A/125VAC 100A / 125VDC 50-60Hz cos φ = 1.0	130	1200	13.60 11.60	•

*) Please note: The holder no. 424 is lead-free, but not the inserted fuse no. 419

Order Information

Qty.	Order-Number	Series	Amp Code	Packaging
		424		

Specifications are subject to change without notice

No. 424 / X-SMQ

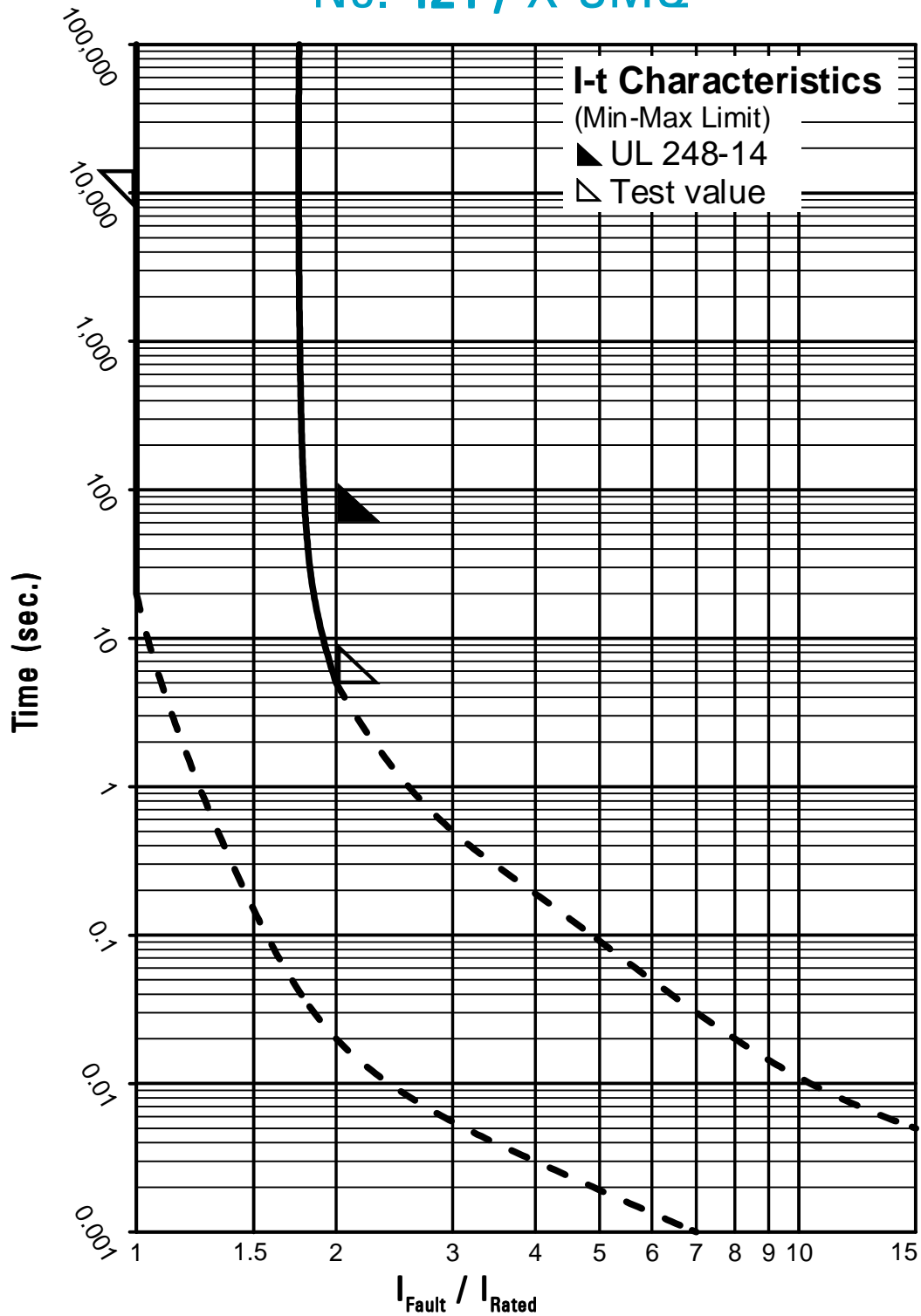

Contact WICKMANN for individual I-t curves