

CMHSH5-4
SURFACE MOUNT
SCHOTTKY RECTIFIER
500mA, 40 VOLTS



SOD-123 CASE

CentralTM
Semiconductor Corp.

DESCRIPTION:

The CENTRAL SEMICONDUCTOR CMHSH5-4 type is a Silicon Schottky Rectifier, epoxy molded in a surface mount package, designed for high current, fast switching applications requiring a low forward voltage drop.

The Marking Code is C54.

MAXIMUM RATINGS (T_A=25°C unless otherwise noted)

	<u>SYMBOL</u>		<u>UNITS</u>
Peak Repetitive Reverse Voltage	V _R RRM	40	V
Peak Working Reverse Voltage	V _R RWM	40	V
DC Blocking Voltage	V _R	40	V
Average Rectified Current	I _O	500	mA
Peak Repetitive Forward Current (@ rated V _R , square wave, 20kHz, T _C =115°C)	I _{FRM}	1.0	A
Peak Forward Surge Current (@ rated load, halfwave, single phase, 60Hz)	I _{FSM}	5.5	A
Junction Temperature	T _J	-65 to +125	°C
Storage Temperature	T _{stg}	-65 to +150	°C
Thermal Resistance	Θ _{JL}	118	°C/W
Thermal Resistance	Θ _{JA}	206	°C/W

ELECTRICAL CHARACTERISTICS (T_A=25°C unless otherwise noted)

<u>SYMBOL</u>	<u>TEST CONDITIONS</u>	<u>MIN</u>	<u>TYP</u>	<u>MAX</u>	<u>UNITS</u>
I _R	V _R =20V			10	μA
I _R	V _R =20V, T _A =100°C			5.0	mA
I _R	V _R =40V			20	μA
I _R	V _R =40V, T _A =100°C			13	mA
V _F	I _F =500mA			510	mV
V _F	I _F =500mA, T _A =100°C			460	mV
V _F	I _F =1.0A			620	mV
V _F	I _F =1.0A, T _A =100°C			610	mV
C _T	V _R =4.0V, f=1.0MHz		50		pF

MECHANICAL OUTLINE - SOD-123

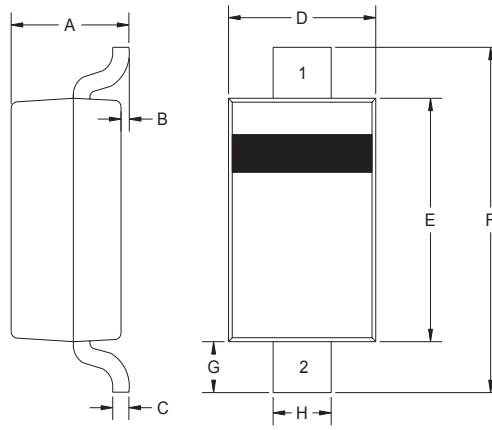

R3

DIMENSIONS				
SYMBOL	INCHES		MILLIMETERS	
	MIN	MAX	MIN	MAX
A	0.037	0.053	0.95	1.35
B	-	0.005	-	0.12
C	-	0.008	-	0.20
D	0.055	0.071	1.40	1.80
E	0.098	0.112	2.50	2.84
F	0.140	0.154	3.55	3.90
G	0.010	-	0.25	-
H	0.020	0.028	0.50	0.70

SOD-123 (REV:R3)

Lead Code:

- 1) Cathode**
- 2) Anode**

The Marking Code is C54.

R2 (2-November 2001)