

液晶之友 电话: 020-33819057
Http://www.lcdfriends.com

FRONT
↑

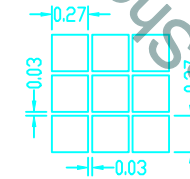

DETAIL B:

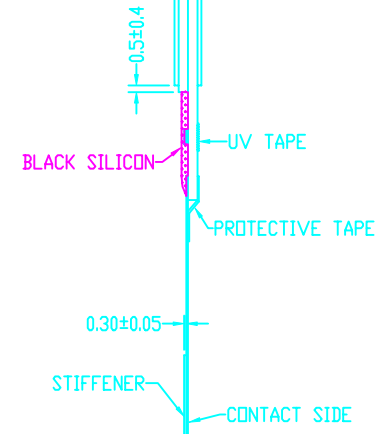
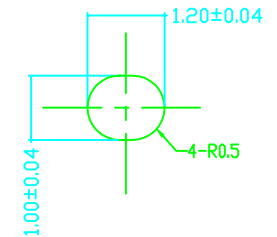

NOTES:

1. DISPLAY TYPE: FSTN
2. VIEWING DIRECTION: 12:00
3. POLARIZER MODE: TRANSFLECTIVE/POSITIVE
4. DRIVE METHOD: 1/65 DUTY 1/9 BIAS
5. LCD OPERATING VOLTAGE: 9.0V
6. OPERATING TEMP.: -20°C~+70°C
7. STORAGE TEMP.: -30°C~+80°C
8. CONTROLLER: NT7502H-BDT
9. VDD=3.0V
10. CONNECTOR: FPC
11. WITHOUT BACKLIGHT
12. UNMARKED TOLERANCES: ±0.3mm

NO.	PIN	NO.	PIN	NO.	PIN
1	NC	11	CAP3+	21	NC
2	NC	12	CAP1-	22	NC
3	CS1	13	CAP1+		
4	RES	14	CAP2+		
5	A0	15	CAP2-		
6	D6(SCL)	16	V1		
7	D7(SI)	17	V2		
8	VDD	18	V3		
9	VSS	19	V4		
10	VOUT	20	V0		



TIAN-MA MICROELECTRONICS CO.

6/F., CASTIC Building, Shennan Road, Central, Shenzhen, China

DRAWN BY:	TITLE: TM13265ECIWUG	
CHECKED BY:	DWG NO: G-1	
APPROVED BY:	DWG NAME: TM13265ECIWUG-SHEET NO: OF	SCALE: mm
CONFIRMED BY:		UNIT: mm