

# 5,000 V - 16,000 V Rectifiers

10 mA - 40 mA Forward Current

30 ns - 50 ns Recovery Time

**M50FF3 M50FF5**  
**M100FF3 M100FF5**  
**M160FF3 M160FF5**

AXIAL LEADED  
 HERMETICALLY SEALED



**4**

## ELECTRICAL CHARACTERISTICS AND MAXIMUM RATINGS

Part Number	Working Reverse Voltage (V <sub>rrm</sub> )	Average Rectified Current (I <sub>o</sub> )		Reverse Current @ V <sub>rrm</sub> (I <sub>r</sub> )		Forward Voltage (V <sub>f</sub> )		1 Cycle Surge Current t <sub>p</sub> =8.3ms (I <sub>fsm</sub> )	Repetitive Surge Current (I <sub>frm</sub> )	Reverse Recovery Time (3) (T <sub>rr</sub> )	Thermal Impedance θ <sub>J-L</sub>			Junction Cap. @50VDC @ 1kHz (C <sub>j</sub> )
		55°C(1)	100°C(2)	25°C	100°C	25°C					L=.000	L=.125	L=.250	
		Volts	mA	mA	µA	µA	Volts				mA	Amps	Amps	
M50FF3	5000	40	20	0.1	10	12.5	40	2.0	0.4	30	18	30	50.0	1.0
M100FF3	10000	20	10	0.1	10	25.0	20	1.0	0.2	30	18	30	50.0	0.5
M160FF3	16000	10	5	0.1	10	50.0	10	0.5	0.1	30	33	45	65.0	0.5
M50FF5	5000	40	20	0.1	10	12.5	40	2.0	0.4	50	18	30	50.0	1.0
M100FF5	10000	20	10	0.1	10	25.0	20	1.0	0.2	50	18	30	50.0	0.5
M160FF5	16000	10	5	0.1	10	50.0	10	0.5	0.1	50	33	45	65.0	0.5

(1)TL=55°C L=0.375" (2)TL=100°C L=0.375" (3)I<sub>f</sub>=12.5mA, I<sub>r</sub>=25mA, I<sub>rr</sub>=6.3mA • Op.Temp.= -65°C to +175°C Stg.Temp.= -65°C to +200°C

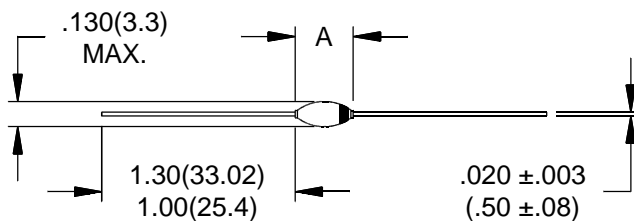

Part	A
M50FFX M100FFX	.300(7.62) MAX.
M160FFX	.350(8.89) MAX.



Dimensions: In. (mm) • All temperatures are ambient unless otherwise noted. • Data subject to change without notice.



**VOLTAGE MULTIPLIERS INC.**  
 8711 W. Roosevelt Ave.  
 Visalia, CA 93291

TEL 559-651-1402  
 FAX 559-651-0740  
[www.voltagemultipliers.com](http://www.voltagemultipliers.com)

**M50FF3 M100FF3 M160FF3 M50FF5 M100FF5 M160FF5**

