

Electrical / Environmental

HM67

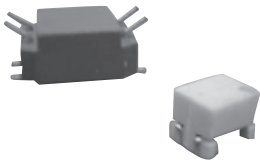

Surface Mount Common Mode Chokes

- Operating Temperature Range -40°C to +125°C
- Ambient Temperature, Maximum 85°C
- Temperature Rise, Maximum 40°C
- Dielectric Withstanding Voltage 300Vdc

Schematic

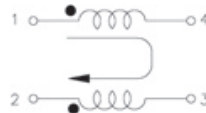

Specifications

| Part Number | Terminals | Common Mode Inductance | Inductance Leakage | Rated Current mA | DCR (2) | Marking Code | Figure |
|--------------------------|-----------|---|---|------------------|---------|--------------|--------|
| | | @ 100 kHz - 0.1 V (1-4 or 2-3) μH | @ 100 kHz - 0.1 Vrms (1-4) ⁽¹⁾ Typ. μH | | Max. mΩ | | |
| HM67-B5R0 | 1-4, 2-3 | 5.0 ±30% | 0.08 | 1000 | 7.2 | A | 1 |
| HM67-B110 | 1-4, 2-3 | 11.0 ±30% | 0.10 | 500 | 5.8 | B | 1 |
| HM67-S250 | 1-4, 2-3 | 25.0 ±30% | 1.60 | 500 | 9.8 | C | 1 |
| HM67-B510 | 1-4, 2-3 | 51.0 ±30% | 1.90 | 500 | 7.2 | D | 1 |
| HM67-S510 | 1-4, 2-3 | 51.0 ±30% | 2.80 | 500 | 9.4 | E | 1 |
| HM67-B471 | 1-4, 2-3 | 470.0 ±30% | 0.80 | 500 | 8.2 | F | 1 |
| HM67-B102 ⁽³⁾ | 1-4, 2-3 | 1000.0 +50%, -30% | 0.16 | 500 | 9.4 | G | 1 |
| HM67-B222 ⁽³⁾ | 1-4, 2-3 | 2200.0 +50%, -30% | 0.16 | 400 | 8.2 | H | 1 |
| HM67-B472 ⁽³⁾ | 1-4, 2-3 | 4700.0 +50%, -30% | 0.24 | 200 | 9.8 | I | 1 |
| HM67-10510 | 1-4, 2-3 | 51.0 ±30% | 2.40 | 200 | 403 | 0510 | 2 |

- Notes:
- (1) Leakage inductance is measured with pin 2 & 3 shorted.
 - (2) DC resistance is measured at 25°C.
 - (3) Maximum operating temperature is +85°C.

Packaging

Standard: Embossed Tape & Reel

| | | | | |
|-------|-----------|--------------|---|---------------|
| Reel: | Diameter: | Figure 1 & 2 | = | 13" (330.2mm) |
| | Capacity: | Figure 1 | = | 400 Units |
| | | Figure 2 | = | 2000 Units |

Ordering Information

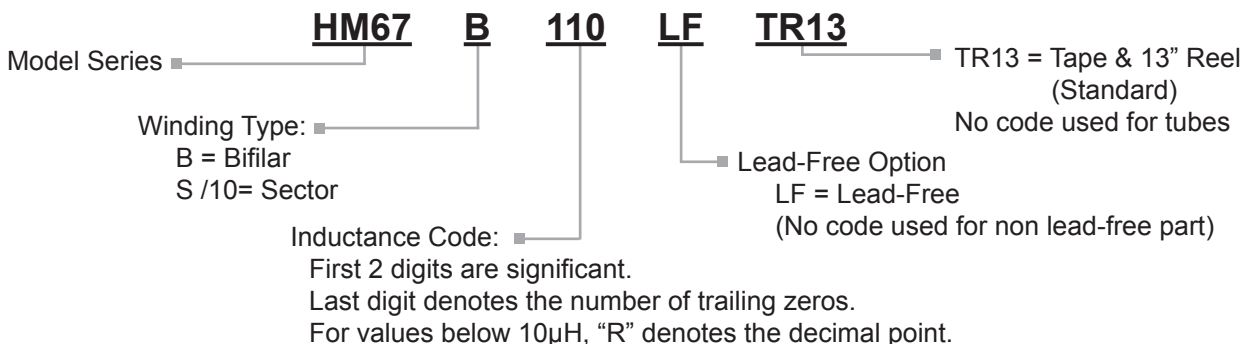

Outline Dimensions (Inch/mm)

Figure 1

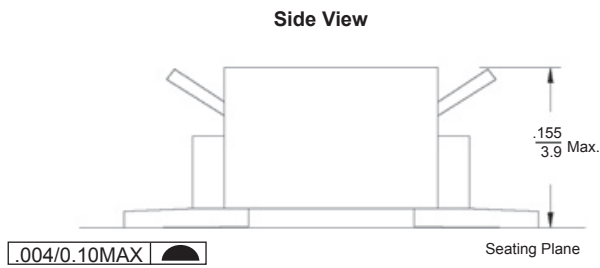
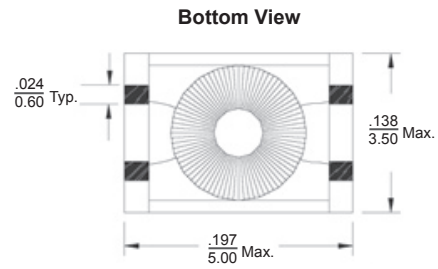
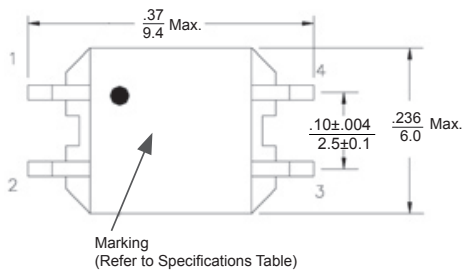

Figure 2



Top View



Top View

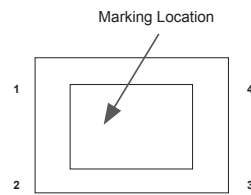

Side View

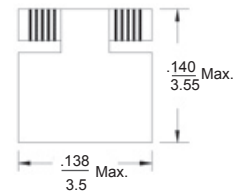

Recommended Solder Pad Layout

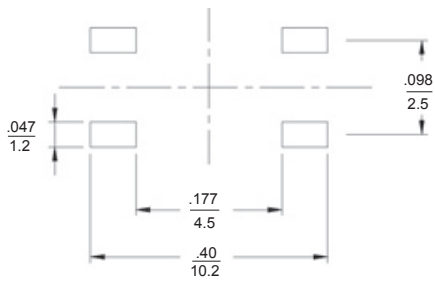

Recommended Solder Pad Layout

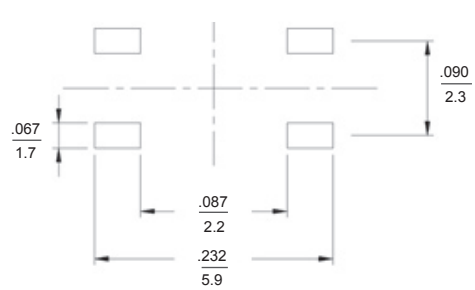

Electrical Characteristics @ 25 °C

(A) Attenuation vs. Frequency Graphs

HM67-B5R0

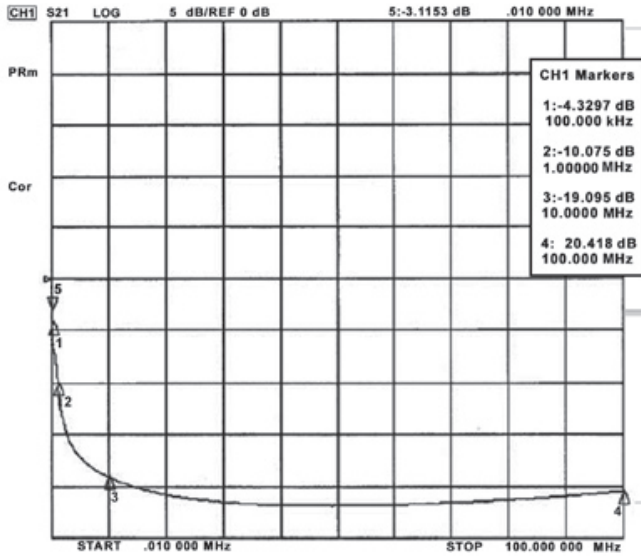

HM67-S250

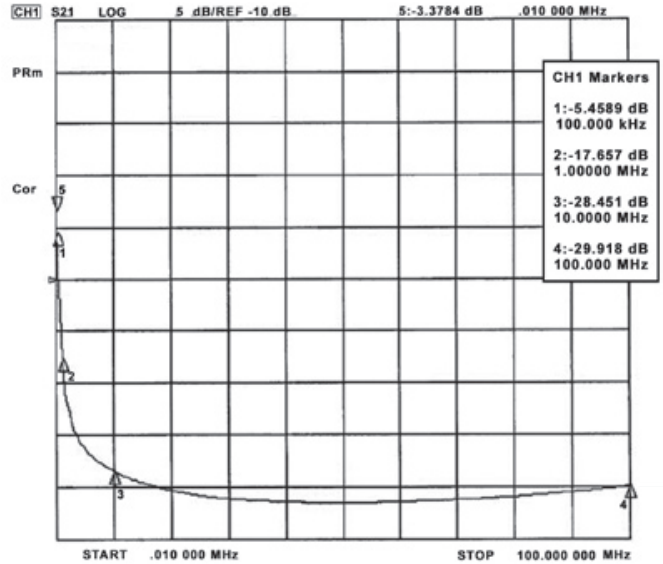

HM67-B110

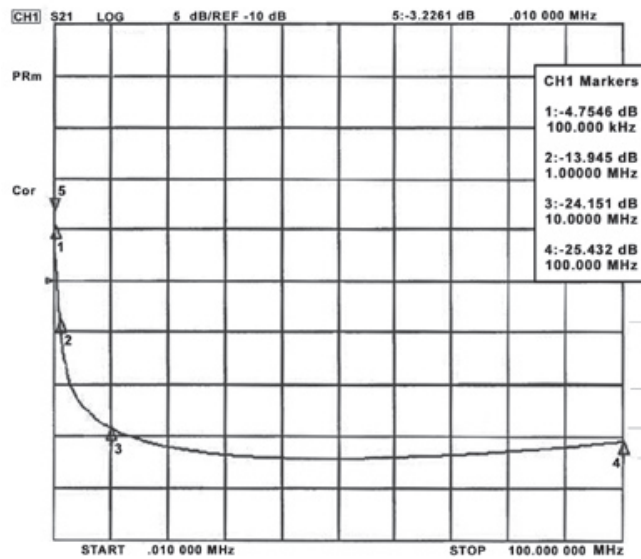

HM67-B510

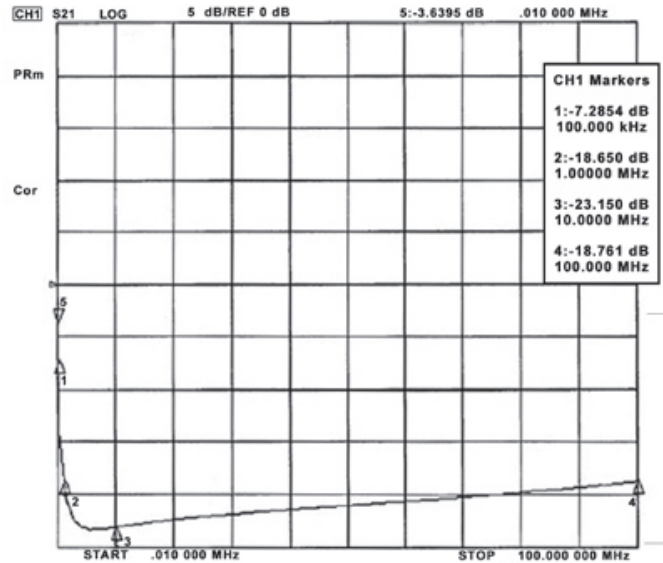

Electrical Characteristics @ 25 °C (Cont'd)

HM67-S510

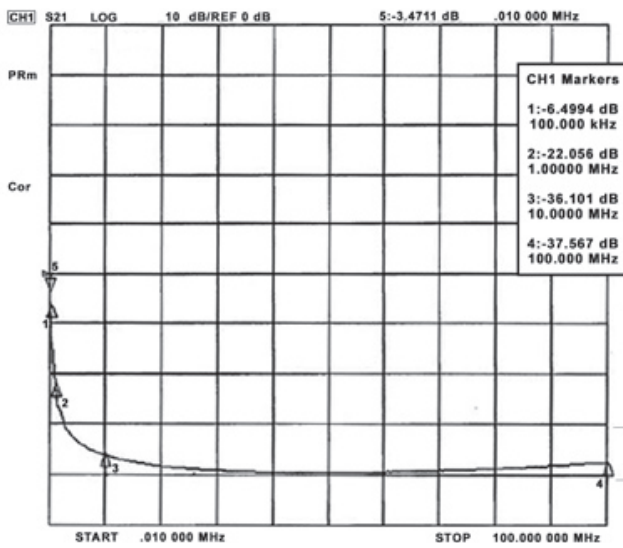

HM67-B102

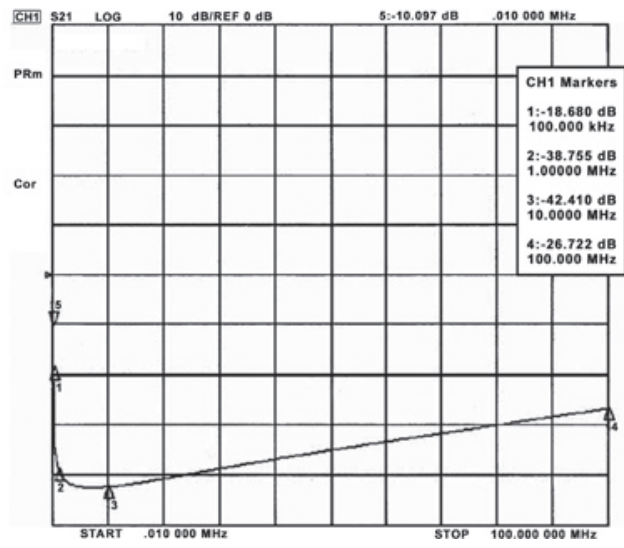

HM67-B471

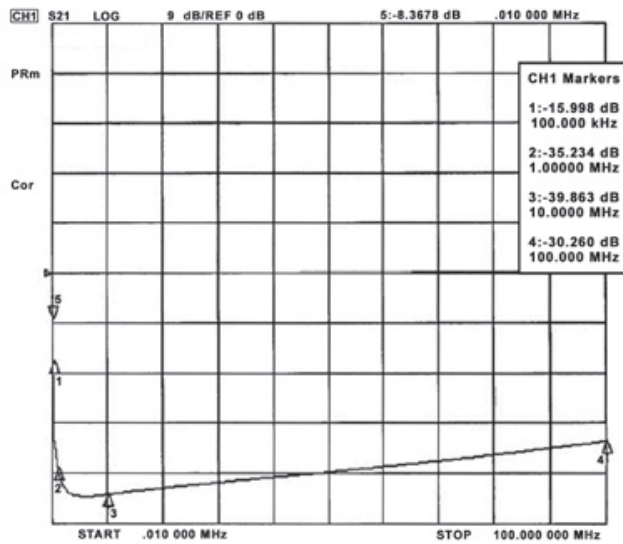

HM67-B222

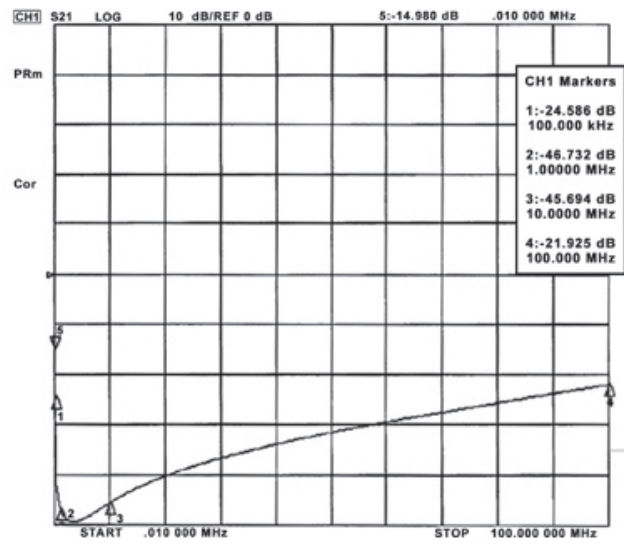

HM67-B472

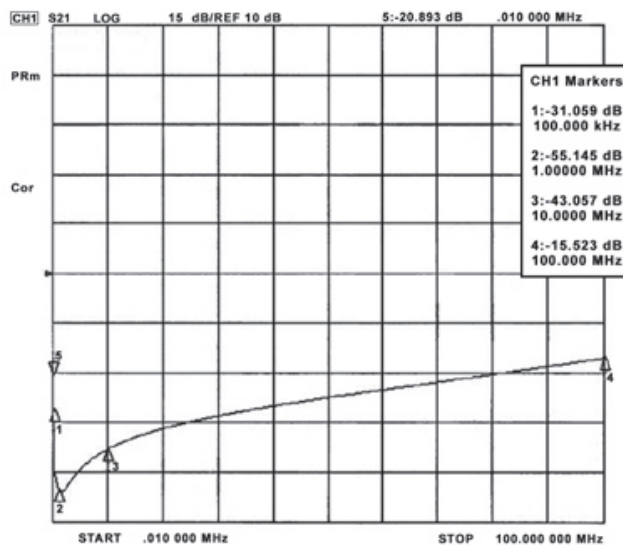

Electrical Characteristics @ 25 °C (Cont'd)

(B) Insertion Loss vs. Frequency Graph

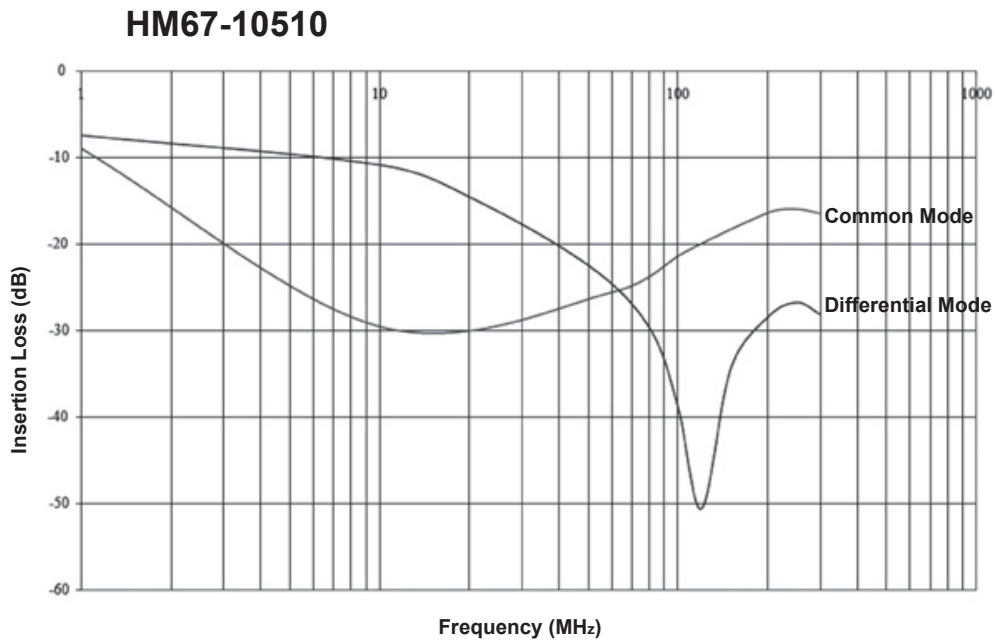

(C) Current Derating Curve

