

# FULL COLOR PANEL DISPLAY UNITS

480 × 480 mm

16 × 16 Dots LNP721031G

Outline Drawing

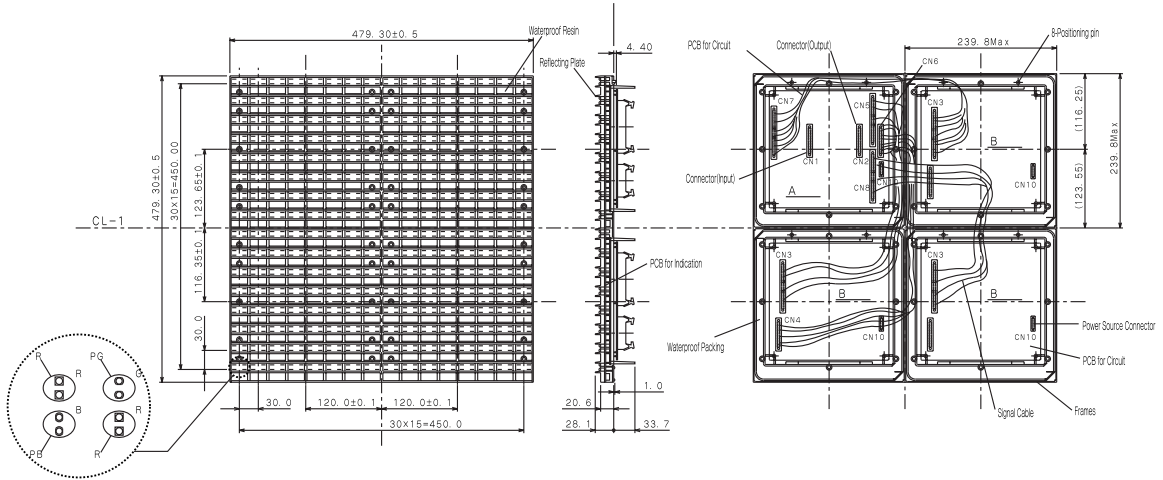

## Absolute Maximum Ratings (Ta = 25°C)

Item	Symbol	Rated	Unit
Supply Voltage for Logic	V <sub>CC</sub>	+ 5.5	V
Supply Voltage for LED	V <sub>LED</sub>	R: + 5.5 PG: + 5.5 PB: + 5.5	V
Input Voltage	V <sub>in</sub>	- 0.3 ~ V <sub>CC</sub> + 0.3	V
Operating Ambient Temperature	T <sub>opr</sub>	- 20 ~ + 45	°C
Storage Temperature	T <sub>stg</sub>	- 30 ~ + 80	°C

## Main Specifications (Ta = 25°C)

Item	Symbol	Rated	Unit	
Display Colors		Full Color (Red, Green, Blue)		
Display Surface Size		480 × 480	mm	
Dot Total Number		256 (16 × 16)		
Dot Structure		R:2 PG:1 PB:1		
Dots Pitch		30.0	mm	
Brightness (when lighting all lamps)	B	R:1010 PG:1930 PB:320 W:3000	cd/m <sup>2</sup>	
Dots Brightness Variation		± 26	%	
Area Gradation		R:PG:PB 256 gradation for each color		
Modulated Light		8		
Peak Emission Wavelength (Typ)	λ <sub>p</sub>	R:620 PG:525 PB:468	nm	
Viewing Angle (50 % Luminous)	2θ 1/2	Level 70, Up10, Down 18	°	
Operating Method		Static lighting		
Operating Frequency	f <sub>CLK</sub>	2	MHz	
Scan Frequency	f <sub>ECLK</sub>	8		
for Logic	Supply Voltage	V <sub>CC</sub>	5.0	V
	Supply Current	I <sub>CC</sub>	Max 1.0	A
for LED	Supply Voltage	V <sub>R</sub> ·V <sub>PG</sub> ·V <sub>PB</sub>	5.0	V
	Supply Current	I <sub>R</sub> ·I <sub>PG</sub> ·I <sub>PB</sub>	Max 7.8	A
Mass		3700	g	