

# 150mA Low Dropout Voltage Regulator

## FEATURES

- 5V Fixed Output
- 150mA current capability
- 250mV Dropout
- Programmable Reset Threshold
- 250 $\mu$ A Quiescent Current
- Over Temperature Protection
- Reverse Polarity Protection
- Integrated Pull Up Resistor on Logic Outputs
- -40° to 125°C Operating Range
- Available in 8 Pin and 14 Pin nSOIC or 20 Pin wSOIC packages.



*Now Available in Lead Free Packaging*

## APPLICATIONS

- Automotive
- Industrial
- Wireless Base Station

## DESCRIPTION

Sipex's SPX2969 is a low dropout linear regulator with integrated PNP pass transistor. The part is designed for automotive environment, and thus can withstand up to 45V and 125°C temperature range. The output voltage is set at a fixed 5V, and the part is guaranteed to deliver at least 150mA. The SPX2969 provides multiple protection mechanisms, including over-temperature and over-current conditions. The part has a built-in reset circuit to monitor when the output voltage is below 4.65V. The reset voltage threshold can be programmed down to 3.5V using an external resistor voltage divider, while the reset timing can be programmed via an external capacitor. A built in comparator compares the signal of the pin SI, normally fed by a voltage divider from the input voltage, with the reference and gives an early warning on the pin SO. Both the sense output and the reset output delay signals contain integrated 20kOhm pull up resistors. The part is available in three package types: 8 Pin and 14 Pin nSOIC or 20 Pin wSOIC packages.

## TYPICAL APPLICATION CIRCUIT

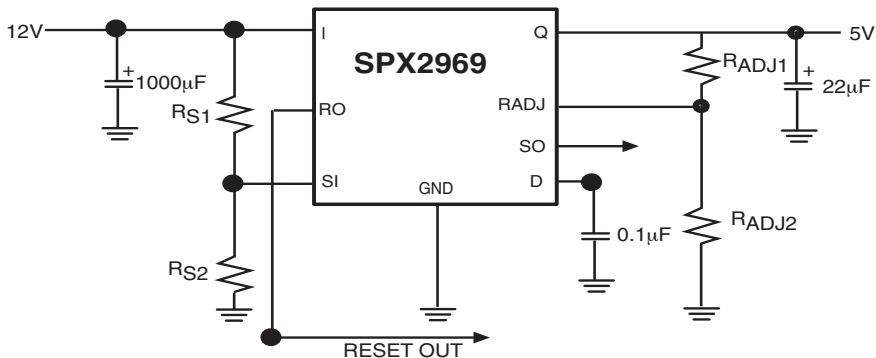

## ABSOLUTE MAXIMUM RATINGS

Input Voltage .....	-40V to 45V
Input Current .....	internally limited
Sense Input Voltage .....	-40V to 45V
Sense Input Current .....	-1mA to 1mA
Reset Threshold Voltage .....	-0.3 to 7V
Reset Threshold Current .....	-10 to 10mA
Reset Delay Voltage .....	-0.3 to 7V
Reset Delay Current .....	internally limited
Ground Current .....	50mA (min)
Reset Output Voltage .....	-0.3 to 7V
Reset Output Current .....	internally limited
Sense Output Voltage .....	-0.3 to 7V
Sense Output Current .....	internally limited

Output Voltage .....	-0.3 to 7V
Output Current .....	internally limited
Thermal Data	
Junction Ambient (8 Pin NSOIC) .....	163°C/W
Junction Ambient (20 Pin WSOIC) .....	70°C/W
Junction Ambient (14 Pin NSOIC) .....	70°C/W
Storage Temperature .....	-50°C to +150°C
Junction Temperature.(Note 1).....	-50°C+150°C

These are stress ratings only and functional operation of the device at these ratings or any other above those indicated in the operation sections of the specifications below is not implied. Exposure to absolute maximum rating conditions for extended periods of time may affect reliability.

## ELECTRICAL CHARACTERISTICS

$V_{IN} = 13.5V$ ;  $-40^{\circ}C < T_J < 125^{\circ}C$ . The  $\blacklozenge$  denotes the specifications which apply over the full operating temperature range, unless otherwise specified.

PARAMETER	SYMBOL	MIN	TYP	MAX	UNITS		CONDITIONS
Output Volatage	$V_O$	4.90	5.00	5.10	V	$\blacklozenge$	$1mA < I_O < 100mA$ $6V < V_I < 16V$
Current Limit	$I_O$	150	250	500	mA	$\blacklozenge$	-
Current Consumption $I_q = I_I - I_O$	$I_q$	-	240	300	$\mu A$		$I_O < 1 mA, T_J < 85^{\circ} C$
Current Consumption $I_q = I_I - I_O$	$I_q$	-	250	700	$\mu A$	$\blacklozenge$	$I_O = 10mA$
Current Consumption $I_q = I_I - I_O$	$I_q$	-	2	8	mA	$\blacklozenge$	$I_O = 50mA$
Drop Voltage	$V_{DR}$	-	0.25	0.5	V	$\blacklozenge$	$I_O = 100mA (Q - I)$ when output drops below 2% (see note 2)
Load Regulation	$V_O$	-	2	20	mV	$\blacklozenge$	$I_O = 5mA$ to 100mA
Line Regulation	$V_O$	-	1	10	mV	$\blacklozenge$	$V_I = 6V$ to 26V $I_O = 1 mA$
<b>Reset Generator</b>							
Threshold Voltage	$V_{RT}$	4.50	4.65	4.80	V	$\blacklozenge$	-
Reset Adjust	$V_{RADJ, TH}$	1.26	1.35	1.44	V	$\blacklozenge$	$V_O = 3.5V$ (see note 3)
Reset Pullup	-	10	20	40	K	$\blacklozenge$	-
Saturation Voltage	$V_{RO, SAT}$	-	0.1	0.4	V	$\blacklozenge$	$R_{intern}$

**Note 1:** Specifications in the  $-40^{\circ}C$  to  $150^{\circ}C$  range are guaranteed by design, not production tested.

**Note 2:** Drop voltage =  $V_I - V_O$  measured when the output voltage has dropped 100mV from the nominal value obtained at 13.5V input.

**Note 3:** The reset threshold  $V_{RT}$  can be decreased via an external voltage divider connected to the RADJ. In this case the reset condition is reached if  $V_O < V_{RT}$  and  $V_{RADJ} < V_{RADJ, TH}$ . Dimensioning the voltage divider according to:  $V_{THRES} = V_{RADJ, TH} \times (RADJ1 + RADJ2) / RADJ2$ .

## ELECTRICAL CHARACTERISTICS

$V_{IN} = 13.5V$ ;  $-40^{\circ}C < T_J < 125^{\circ}C$ . The  $\blacklozenge$  denotes the specifications which apply over the full operating temperature range, unless otherwise specified.

PARAMETER	SYMBOL	MIN	TYP	MAX	UNITS		CONDITIONS
<b>Reset Generator</b>							
Upper Delay Switching Threshold	$V_{UD}$	1.4	1.8	2.2	V	$\blacklozenge$	-
Lower Delay Switching Threshold	$V_{LD}$	0.3	0.45	0.60	V	$\blacklozenge$	-
Saturation Voltage Delay Capacitor	$V_{D, SAT}$	-	-	0.1	V	$\blacklozenge$	$V_Q < V_{RT}$
Charge Current	$I_D$	3.0	6.5	9.5	$\mu A$	$\blacklozenge$	$V_D = 1V$
Delay Time L' H	$t_D$	17	28	-	ms	$\blacklozenge$	$C_D = 100nF$
Delay Time H' L	$t_t$	-	1	-	$\mu s$	$\blacklozenge$	$C_D = 100nF$
<b>Input Voltage Sense</b>							
Sense Threshold High	$V_{SI, high}$	1.24	1.31	1.38	V	$\blacklozenge$	-
Sense Threshold Low	$V_{SI, low}$	1.16	1.20	1.28	V	$\blacklozenge$	-
Sense Output low Voltage	$V_{SO, low}$	-	0.1	0.4	V	$\blacklozenge$	$V_{SI} < 1.20V$ $V_Q > 3V$ $R_{intern}$
Sense Pull up	-	10	20	40	K	$\blacklozenge$	-
Sense Input Current	$i_{si}$	-1	0.1	1	$\mu A$	$\blacklozenge$	-
Sense Response Time	-		2		$\mu s$	$\blacklozenge$	-

The input capacitor  $C_i$  is necessary for compensating line influences. Using a resistor of approximately  $1\Omega$  in series with  $C_i$ , the oscillating circuit consisting of input inductivity and input capacitance can be damped. The output capacitor  $C_o$  is necessary for the stability of the regulating circuit. Stability is guaranteed at values  $\geq 10\mu\text{F}$  and an  $\text{ESR} \leq 10\Omega$  within the operating temperature range. For small tolerances of the reset delay the spread of the capacitance of the delay capacitor and its temperature coefficient should be noted.

BLOCK DIAGRAM

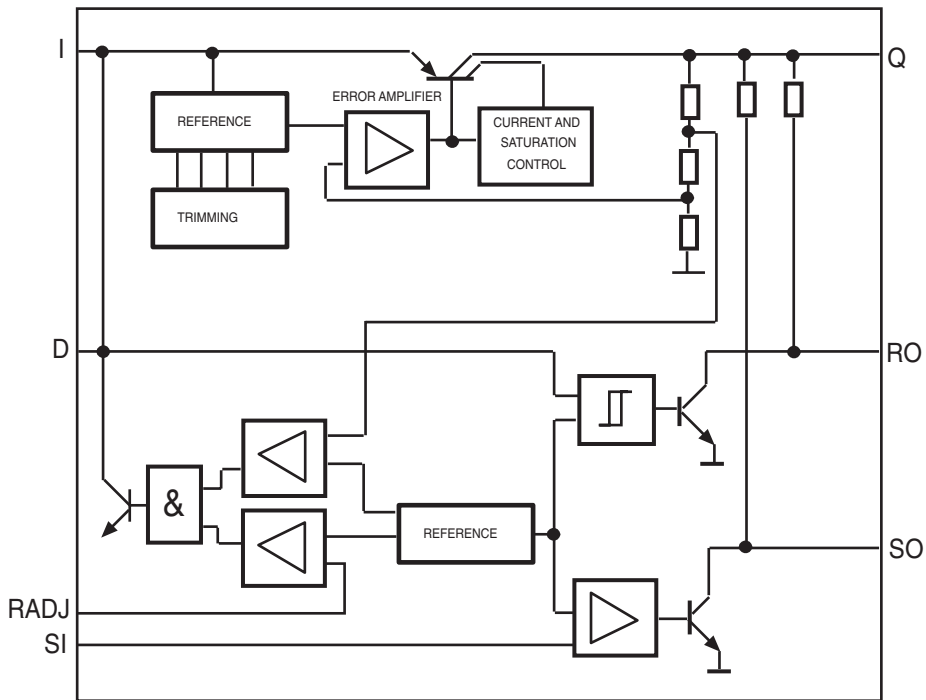

PIN NUMBER	PIN NAME	DESCRIPTION (8 PIN NOIC)
1	V <sub>IN</sub>	Input. block to GND with a Ceramic capacitor.
2	SENSE IN	Sense Input. If not need connect to Q
3	R <sub>ADJ</sub>	Reset Threshold Adj. If not needed connect to GND
4	DELAY	Reset Delay. To select delay time, connect to GND via capacitor.
5	GND	Ground
6	RESET	Reset Output. The open-collector output is internally linked to Q via a resistor. Keep it open if not needed.
7	SENSE OUT	Sense Output. The open-collector output is internally linked to Q via a resistor. Keep it open if not needed.
8	V <sub>OUT</sub>	5V Output. Connect to GND with a 10μF capacitor, ESR<10

PIN NUMBER	PIN NAME	DESCRIPTION (20 PIN WIDE NOIC)
1	R <sub>ADJ</sub>	Reset Threshold Adj. If not needed connect to GND
2	DELAY	Reset delay. To select delay time, connect to GND via capacitor.
3	NC	No Connect
4	GND	Ground
5	GND	Ground
6	GND	Ground
7	GND	Ground
8	NC	No connect
9	NC	No connect
10	RESET	Reset Output. The open-collector output is internally linked to Q via a 20K ohm pullup resistor. Keep open if not needed.
11	SENSE OUT	Sense output. The open collector output is internally linked to the output via a 20k ohm pullup resistor. Keep open if not needed.
12	V <sub>OUT</sub>	5V Output. Connctet to GND with a 10 uF capacitor, ESR<10
13	NC	No Connect
14	GND	Ground
15	GND	Ground
16	GND	Ground
17	GND	Ground
18	NC	No Connect
19	V <sub>IN</sub>	Input. Bypass to GND directly at the IC with a ceramic capacitor.
20	SENSE IN	Sense Input. If not needed connect to V <sub>OUT</sub>

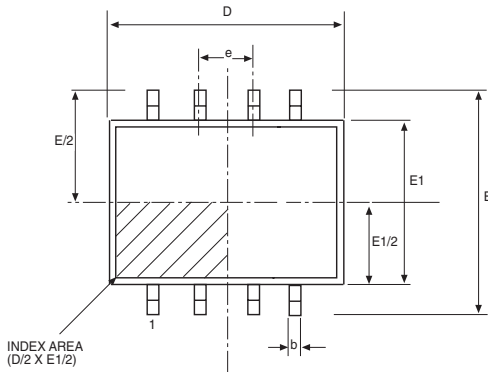

TOP VIEW

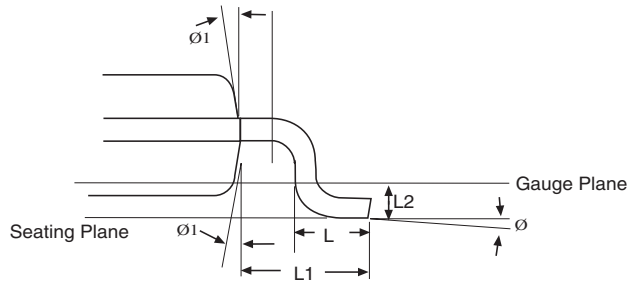
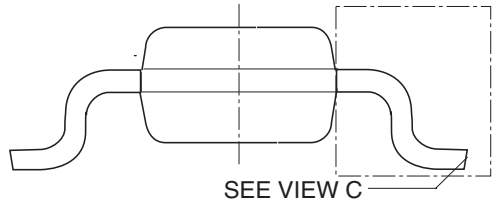

VIEW C

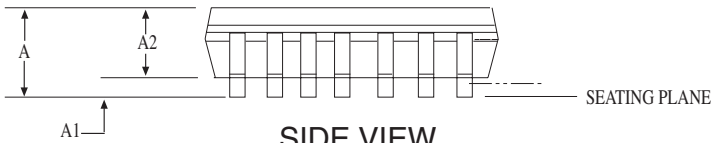

SIDE VIEW

8 Pin NSOIC (JEDEC MS-012, AA - VARIATION)	DIMENSIONS Minimum/Maximum (mm)		
	COMMON HEIGHT DIMENSION		
SYMBOL	MIN	NOM	MAX
A	1.35	-	1.75
A1	0.10	-	0.25
A2	1.25	-	1.65
b	0.31	-	0.51
c	0.17	-	0.25
D	4.90 BSC		
E	6.00 BSC		
E1	3.90 BSC		
e	1.27 BSC		
L	0.40	-	1.27
L1	1.04 REF		
L2	0.25 BSC		
Ø	0°	-	8°
Ø1	5°	-	15°

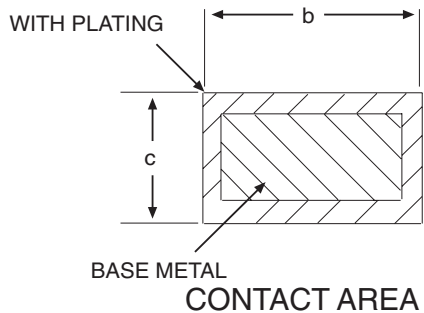

**PACKAGE: 8 PIN NSOIC**

(Narrow refers to symbol E1)

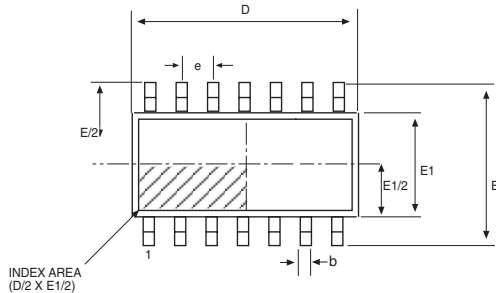

TOP VIEW

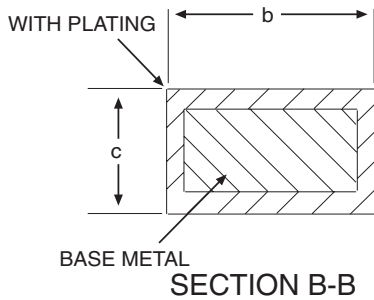

SECTION B-B

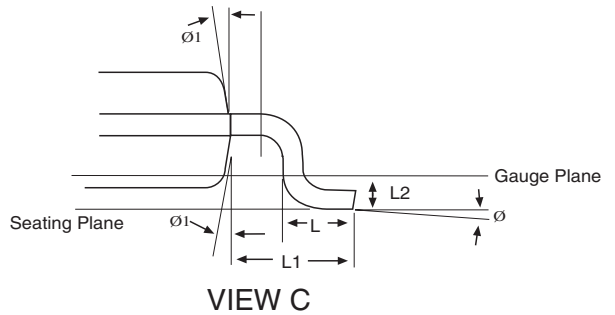
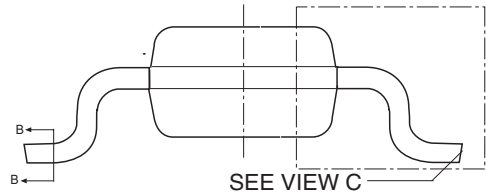

VIEW C

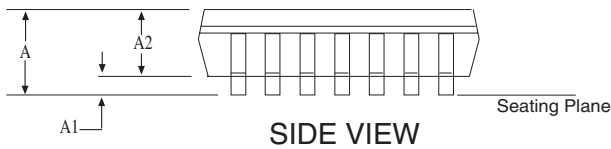

SIDE VIEW

14 Pin NSOIC (JEDEC MS-012, AB - VARIATION)	DIMENSIONS in (mm)			
	SYMBOL	MIN	NOM	MAX
	A	1.35	-	1.75
	A1	0.10	-	0.25
	A2	1.25	-	1.65
	b	0.31	-	0.51
	c	0.17	-	0.25
	D	8.65 BSC		
	E	6.00 BSC		
	E1	3.90 BSC		
	e	1.27 BSC		
	L	0.40	-	1.27
	L1	1.04 REF		
	L2	0.25 BSC		
	Ø	0°	-	8°
	Ø1	5°	-	15°

14 PIN NSOIC

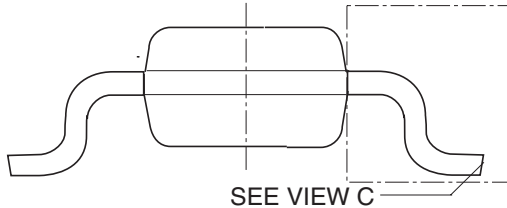
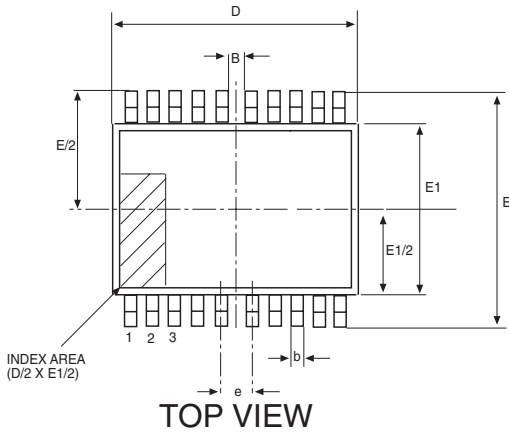

SEE VIEW C

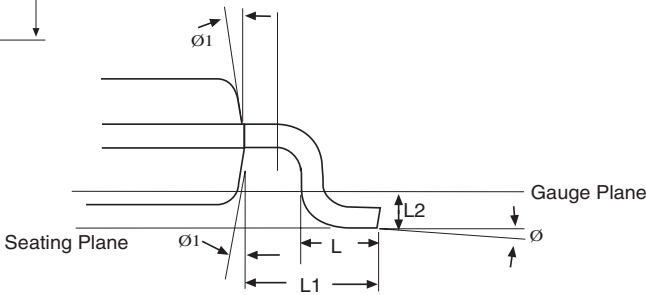

VIEW C

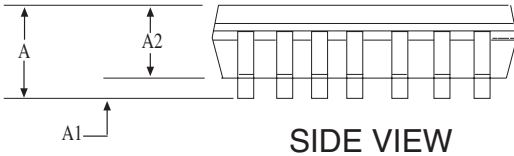

SIDE VIEW

20 Pin SOIC (WIDE) (JEDEC MS-013, AC - VARIATION)		DIMENSIONS Minimum/Maximum (mm)		
COMMON HEIGHT DIMENSION				
SYMBOL	MIN	NOM	MAX	
A	2.35	-	2.65	
A1	0.10	-	0.30	
A2	2.05	-	2.55	
b	0.31	-	0.51	
c	0.20	-	0.30	
D	12.80 BSC			
E	10.30 BSC			
E1	7.50 BSC			
e	1.27 BSC			
L	0.40	-	1.27	
L1	1.04 REF			
L2	0.25 BSC			
Ø	0°	-	8°	
Ø1	5°	-	15°	

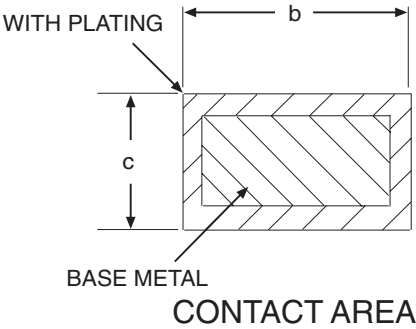

20 PIN WSOIC  
(wide refers to symbol E1)



---

**ORDERING INFORMATION**

<b>Part number</b>	<b>Output Voltage</b>	<b>Package Type</b>
SPX2969S .....	5.0V .....	8 Pin NSOIC
SPX2969S/TR .....	5.0V .....	8 Pin NSOIC
SPX2969S1/TR .....	5.0V .....	14 Pin NSOIC
SPX2969S1/TR .....	5.0V .....	14 Pin NSOIC
SPX2969W1 .....	5.0V .....	20 Pin WSOIC
SPX2969W1/TR .....	5.0V .....	20 Pin WSOIC

Available in lead free packaging. To order add "-L" suffix to part number.

Example: SPX2969S/TR = standard; SPX2969S-L/TR = lead free

/TR = Tape and Reel

Pack quantity is 1,500 for WSOIC and 2,500 for NSOIC.



**ANALOG EXCELLENCE**

**Sipex Corporation**

**Headquarters and  
Sales Office**  
233 South Hillview Drive  
Milpitas, CA 95035  
TEL: (408) 934-7500  
FAX: (408) 935-7600

Sipex Corporation reserves the right to make changes to any products described herein. Sipex does not assume any liability arising out of the application or use of any product or circuit described herein; neither does it convey any license under its patent rights nor the rights of others.