

VICOR CONFIDENTIAL

THIS DOCUMENT AND THE DATA DISCLOSED
HEREIN OR HEREWITH IS NOT TO BE REPRODUCED,
USED, OR DISCLOSED IN WHOLE OR IN PART
TO ANYONE WITHOUT PERMISSION OF VICOR CORP.

REV.	DESCRIPTION	DATE	APPROVED
03	REVSD & REDWN PER E950112 DPK	4/5/95	RCM

ELECTRICAL CHARACTERISTICS

RATED VOLTAGE:	250 VAC, 50/60 Hz
CAPACITANCE TOLERANCE:	± 10%
DISSIPATION FACTOR:	< 1% MEASURED AT 1 KHZ
MAXIMUM PULSE RISE TIME:	ACCORDING TO VDE 0565 PART 1 du/dt 100V / μSEC
DIELECTRIC:	POLYESTER-FILM
TEST VOLTAGE:	(ELECTRODE/ELECTRODE) 1075 V-, 2 SEC. (SELF HEALINGS ARE ALLOWED TO OCCUR)
INSULATION RESISTANCE:	FOR C ≤ .33μF 15000 MEGOHM MINIMUM VALUE
COATING:	PLASTIC CAN, EPOXY RESIN SEALED, FLAME RETARDANT

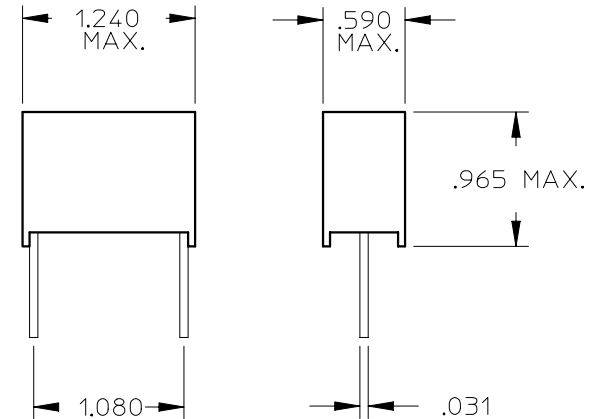

NOTES:

1. APPROVALS INCLUDE VDE, SEV, DEMKO, SEMKO, NEMKO, SETI, UL, IMQ, OVE.
2. LEADS ARE TINNED COPPER WIRE.

UNLESS OTHERWISE SPECIFIED
DIMENSIONS ARE IN INCHES
TOLERANCES ARE:

FRACTIONS	DECIMALS	ANGLES
± 1/64	.XX ± .01	± 1°
	.XXX ± .005	

THIRD ANGLE PROJECTION

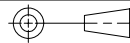

DO NOT SCALE DRAWING

APPROVALS		DATE				
DRAWN: D.P. KELLY		4/95				
CAP, FLM, AXIAL, 1μF, ±10%/250V			SIZE	FSCM NO.	DWG. NO.	REV.
			B	67131	02573	03
SCALE FULL			SHEET 1 OF 1			